

1

USMC Neuville en C droz
Plot: C Row: 5 Gr: 41
Date of Burial: 18 Apr 50
Verified by GRS Officer
M.R. Swart, Capt QMC

DISINTERMENT DIRECTIVE

SECTION A - NAME AND BURIAL LOCATION OF DECEASED

DIRECTIVE NUMBER
1260 01550

DATE
15 08 48
DAY MONTH YEAR

NAME SERIAL NUMBER GRADE ARM RACE RELIGION
UNKNOWN X-005457 0 0 6

CEMETERY PLOT ROW GRAVE DISPOSITION OF REMAINS
NEUVILLE BELGIUM U 12 290 1202 80
CODE DIST. CTR.

SECTION B - CONSIGNEE AND NEXT OF KIN NO FLAG SENT

NAME AND ADDRESS OF CONSIGNEE
NEUVILLE-EN-CONDROZ, BELGIUM

NAME AND ADDRESS OF NEXT OF KIN
(BY XRAY AND INSTRUMENTAL EXAMINATION)
These remains are unidentifiable and are to be permanently interred. (Hq. AGRC-26 Jan 50)

SECTION C - DISINTERMENT AND IDENTIFICATION

NAME SERIAL NUMBER GRADE DATE OF DEATH DATE DISTINTERRED
UNKNOWN X-005457 26 NOV 1948

IDENTIFICATION TAG ON ORGANIZATION RELIGION IDENTIFICATION VERIFIED BY
 REMAINS EMB UNKNOWN UNK VERNON N HOYT 1st Lt INF
 MARKER EMB

SECTION D - PREPARATION OF REMAINS FOR SHIPMENT

NATURE OF BURIAL CONDITION OF REMAINS
UNIFORM REMAINS COMPLETE.
ADVANCED STAGE OF DECOMPOSITION.

OTHER MEANS OF IDENTIFICATION
REPORT OF BURIAL WITH REMAINS READS X-5457

MINOR DISCREPANCIES (Prepare Discrepancy Report QMC Form 1194a for major discrepancies.)
NONE

NAT FILE
RECORDS ANNOTATED
DATE 5 Aug 50
NAME A. G. Johnson
Capt. BR. MEM. DIV.

REMAINS PREPARED AND PLACED IN ~~CASK~~ TRANSFER CASE

DATE 9 DEC 1948 BY CLARENCE R TOMPKINS EMBALMER

CASKET SEALED BY EMBALMER (Signature)
CALVIN WATSON CALVIN WATSON EMBALMER

CASKET BOXED AND MARKED BY STANLEY E GAJEWSKI ALL TAGS, MARKINGS AND PLATES VERIFIED BY:
DATE 12 DEC 48 BY CLERK RECORDER FRANKLIN J ST CLAIR 1st Lt INF

I hereby certify that all the foregoing operations were conducted and accomplished under my immediate supervision and that the report above is correct. / EXCEPT CASKETING

WOODROW W WOLF CAPT QMC
SIGNATURE OF AGRS INSPECTOR

REMARKS AND SPECIAL INSTRUCTIONS
I certify that the entries on this form are true copies of the entries on Copy Number 4 of this Disinterment Directive which contains the signatures of the persons whose names are typed hereon.

Raymond T Rodriguez CWO USA
me 78 JMD

6

DISINTERMENT DIRECTIVE

SECTION A —
NAME AND BURIAL LOCATION OF DECEASED

DIRECTIVE NUMBER
1290 01300

DATE
15 08 48
DAY MONTH YEAR

NAME	SERIAL NUMBER	GRADE	ARM	RACE	RELIGION
UNKNOWN	005457		0	0	0

CEMETERY	PLOT	ROW	GRAVE	DISPOSITION OF REMAINS
NEUVILLE BELGIUM	U	12	290	1202 60
				CODE DIST. CTR.

SECTION B — CONSIGNEE AND NEXT OF KIN

NAME AND ADDRESS OF CONSIGNEE	NAME AND ADDRESS OF NEXT OF KIN
NEUVILLE-EN-CONDROZ, BELGIUM	(BY ADMINISTRATIVE DECISION)

SECTION C — DISINTERMENT AND IDENTIFICATION

NAME	SERIAL NUMBER	GRADE	DATE OF DEATH	DATE DISTINTERRED
IDENTIFICATION TAG ON	ORGANIZATION	RELIGION	IDENTIFICATION VERIFIED BY	
<input type="checkbox"/> REMAINS <input type="checkbox"/> MARKER	UNKNOWN		NAME AND TITLE	

SECTION D — PREPARATION OF REMAINS FOR SHIPMENT

NATURE OF BURIAL	CONDITION OF REMAINS

OTHER MEANS OF IDENTIFICATION

MINOR DISCREPANCIES (Prepare Discrepancy Report QMC Form 1194a for major discrepancies.)

REMAINS PREPARED AND PLACED IN CASKET

DATE	BY	EMBALMER (Signature)

CASKET BOXED AND MARKED	SHIPPING ADDRESS VERIFIED BY
DATE	BY

I hereby certify that all the foregoing operations were conducted and accomplished under my immediate supervision and that the report above is correct.

SIGNATURE OF AGRS INSPECTOR

REMARKS AND SPECIAL INSTRUCTIONS

HEADQUARTERS
AMERICAN GRAVES REGISTRATION COMMAND
EUROPEAN AREA
APO 58 US ARMY

RRE 293

8 August 1949
(Date)

CERTIFICATE OF UNIDENTIFIABILITY OF REMAINS

1. The records pertaining to Unknown X - 5457, Plot U
Row 12, Grave 290, USMC NEUVILLE, Belgium,
have been reviewed and it is the opinion of this Office that sufficient
evidence is not available at the present time to establish the identity
of the deceased concerned. The remains concerned should be classified as
unidentifiable at the present time.
2. Report of Reprocessing of remains was forwarded to your
Office by Transmittal Letter No. 2368, dated 21-7-47.
3. Remarks:

Case reviewed by undersigned Members of the Board of Review:

Col. H.P. HENRY, O-12589

QMC

E.D. Mulvanity
Lt. Col. E.D. MULVANITY, O-359598

QMC

Major R. BERGER, O-251736

ORD

Capt. Jack C. HAYES, O-1577297

QMC

Capt. E.F. PRICE, Jr. O-1588236

QMC

1/Lt. Edward E. STOUT, O-1594512

CE

QUN

Received 72-# 207 10 Aug 49
Not identifiable from
information presently
available

Per 30 Aug

Incl # 12

TOOTH CHART

7 May 1947
 Date

Unknown X-5457

Unknown

Unknown

Last Name

First

Initial

Rank

Serial No.

Unknown

Unknown

Rhine River Ludwigshohe, Germany

Organization

Place of Death

Date of Death

Cause of Death

Est. June 1946

Drowning in Rhine River

Right

Left

	8	7	6	5	4	3	2	1	1	2	3	4	5	6	7	8
	NOTE		A O						CARIE					X	CARIES	
Side views																
TOP																
VIEWS																
Side Views																
	COR	ES	X											X	CARIES	
	16	15	14	13	12	11	10	9	9	10	11	12	13	14	15	16

This dental chart is very important and should be filled in with great care. There are 32 teeth to be accounted for, as shown by the numbers on the chart. Beginning at the middle line in both upper and lower jaws, the teeth are arranged symmetrically on either side and classed as incisors (cutting teeth), cuspids or canines (tearing teeth), bicuspids (chewing teeth), and molars (principal chewing teeth). An examination should be made and findings charted to cover the following basic conditions: Lost teeth, crowned teeth, bridge work, fillings, caries (cavities of decay), dentures (plates), and any deformity of jaws found. See reverse side for illustrations.

Edward Sebastian 162
 Signature of Officer or other person who prepared Tooth chart
Ernest Gaddy
 Verified by G. R. S. Officer
 ERNEST C. GADDY
 CWO USA C.I.P.

(72)

MISSING TEETH... All teeth missing through previous extraction (not those fractured or displaced by recent wounds) should be "X"ed out and labeled, thus:



CROWNED TEETH... Block in solid the crown of tooth (label gold, porcelain, Silver or gold and porcelain), thus:



BRIDGE WORK... Block in solid the crown of tooth (label gold bridge, gold and porcelain bridge), thus:



FILLINGS... Draw filling on tooth as accurately as possible (block in and label gold, silver, cement), thus:



CARIES (CAVITIES)... Outline location and size of cavity, shade in thus:



DENTURES (PLATES)... Draw diagram of relative size and shape of plate, block in teeth attached and indicate retaining clasps on natural teeth with the word "clasp".

ADDITIONAL SPACE FOR FURTHER REMARKS

Spaces: R1-11, 1mm, R2-3, 1mm, R10-11, 1mm
 R11-12, 1mm, R13-15, 7mm, I2-3, 1mm.
 I5-7, 2mm, I10-11, 3mm, I11-12, 1mm
 I13-15, none
 Mesial version, R15
 Distal version, I11
 unerupted before death, R8
 small teeth in fair alignment have turned pink.

(23)

IDENTIFICATION CHECK LIST

(To be completely filled out and attached to each copy
of Report of Interment WD QMC Form 1042)

Unknown X -5457
Cemetery Neuville en Condroz, Belgiu
Plot _____ Row _____ Grave _____

Date processed: 7 May 1947

1. Arrived at cemetery _____
(Hour) (Date)
2. Place of death rhine river district of Ludwigshöhe, Germany
(Name of closest town) (Coordinates and letter Prefix, maps)
MM-4533
(Sheet, scale and serials used)
3. Remains ~~recovered~~ or disinterred by 164th CM Bn
(Name and organization)
4. Evacuated to Cemetery by central identification point
(Name and organization)
5. Description of clothing and equipment: (if clothes do not fit, obtain size from body measurements)

Item	Clothing Markings	Sizes	Indicate unusual markings color, wear, tear, repairs, etc.
* Headgear	<u>None</u> (Type)		
Raincoat	<u>None</u>		
Overcoat	<u>None</u>		
Jacket, Field	<u>None</u>		
Jacket, Combat	<u>None</u>		
Mackinaw	<u>None</u>		
Sweater	<u>None</u>		
Jacket, HBT	<u>None</u>		
* Shirt, Wool OD	<u>None</u>		
Undershirt, Wool	<u>None</u>		
Undershirt, Cotton	<u>None</u>		
Trousers, HBT	<u>None</u>		
* Trousers, Wool OD	<u>None</u>		

Belt, web **None**

Drawers, wool **Remnants of**

Drawers, cotton **None**

Leggings, wool **None**

Socks, cotton **None**

* Shoes **None** (type)

Overshoes **None**

Web Equipment **None** (type)

(Other item) **None**

(Other item) **None**

* If body is nude, sizes of these items should be computed by measuring the remains

Chevrons or
Insignia **None** (Type & location; shirt, jacket, coat, helmet)

Shoulder Patch **None**

Does clothing indicate that deceased was a member of the Air, Ground or Naval Force?

UTD

6. Description of Remains :

Age **UTD** ^{Est.} Height **6' 11 1/8"** Weight **UTD** Description of wounds **UTD**

Bandages or dressings **UTD** Scars **UTD** (Length, width, location)

UTD Tattoos (Number, location — illustrate on separate page)

Outstanding moles, warts or birthmarks **UTD** (Yes-no; description, location)

Sunburn or tan, other than hand and face **UTD**

Complexion **UTD** (Light, medium, dark, clear, pimples, pocks, freckles)

Build **UTD** (Large, fat, thin, muscular)

Hair **Brown approx. 3" long straight** (Color, length, quantity, curly, wavy, straight, whorls, or definite parting)

Hair **UTD** (Baldness, widows peak, distinctive cutting or other characteristics)

Sideburns **UTD** Mustache **UTD** Beard or **UTD** (Color, setting, shape) (Color, size, shape) (Length, heavy)

Goatee **UTD**
 (Light, color, extent)

Eyes **UTD** Eyebrows **UTD**
 (Color, setting, shape) (Color, bushiness, extent across nose)

Nose **UTD** Ears **UTD**
 (Size, shape, straight) (Size, set close to or far from head)

Mouth **UTD** Lips **UTD**
 (Large, medium, small) (Large, full)

Teeth **see tooth chart**
 (White, size, unevenness, spacing, noticeable crowns, fillings, extracts)

Chin **UTD**
 (Prominent, receding, pointed, dimples, double)

Jaw **UTD** Circumference of head in inches **21 inches**
 (Large, small, normal) (Hair band)

Neck **UTD** Larynx **UTD**
 (Size, length, short, normal, wrinkled) (Prominent, normal)

Shoulders **UTD** Arms **UTD**
 (Broad, straight, small, rounded) (Length, muscular, color, extent and quantity of hair)

Hands **missing**

Fingers **missing**
 (Short, thick, long, slender, size of knuckles, missing fingers or joints)

.....
 (Unusual characteristics of fingernails)

Chest **UTD**
 (Size of nipples, color, quantity and extent of hair, large, small, normal)

Waist **UTD**
 (Size of navel, appendectomy, amount, quantity, and color of hair)

Back **UTD** Circumcision **UTD** Pubic Hair **BROWN**
 (Quantity and extent of hair) (Yes-no) (Color)

Hernioplasty **UTD**
 (Yes-no; location)

Legs **UTD**
 (Inset, muscular, knock-kneed, bowed, normal, quantity, color and extent of hair)

Feet **UTD** Toes **UTD**
 (Size, corns, callouses, flat) (Slender, straight, crooked, overlap)

Evidence of healed fractures **None found**
 (Forehead, nose, ears, arms, legs, etc.)

NOTE: Use attached charts "A" and "B" to indicate parts not received.

see chart

7. Have finger prints been placed on Report of Interment? NO (Yes-no)

If not, explain Hands missing

8. Has tooth chart been prepared? Yes (Yes-no) If not, explain _____

9. Remarks Remains received in advanced stage of decomposition.
Remnants of wool drawers found on remains.
No clothing marks found. (Notice of Disinterment states swimming
trunks were marked: M-4246)
Fluoroscopic Examination; negative.
Estimated weight of remains; 100 lbs.
Nothing found to warrant Chemical Laboratory Examination.
As processing at Central Identification Point revealed no positive
identifying clues, this case is classified unknown.

I certify that I have personally viewed the remains of subject deceased and all resulting information has been recorded to the best of my knowledge.

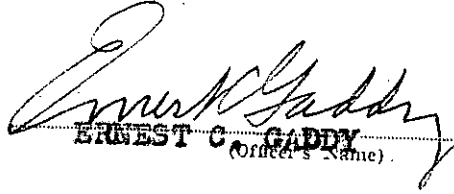
ERNEST C. GADDY
(Officer's Name)

CPO Rank USA Service

CENTRAL IDENTIFICATION POINT
(Organization)

1F-1459
ville en condroz, Belgi
(VK -390187)

SKELETAL CHART

Unknown X-5457
(BLACK OUT PARTS OF BODY NOT RECEIVED AT CEMETERY)

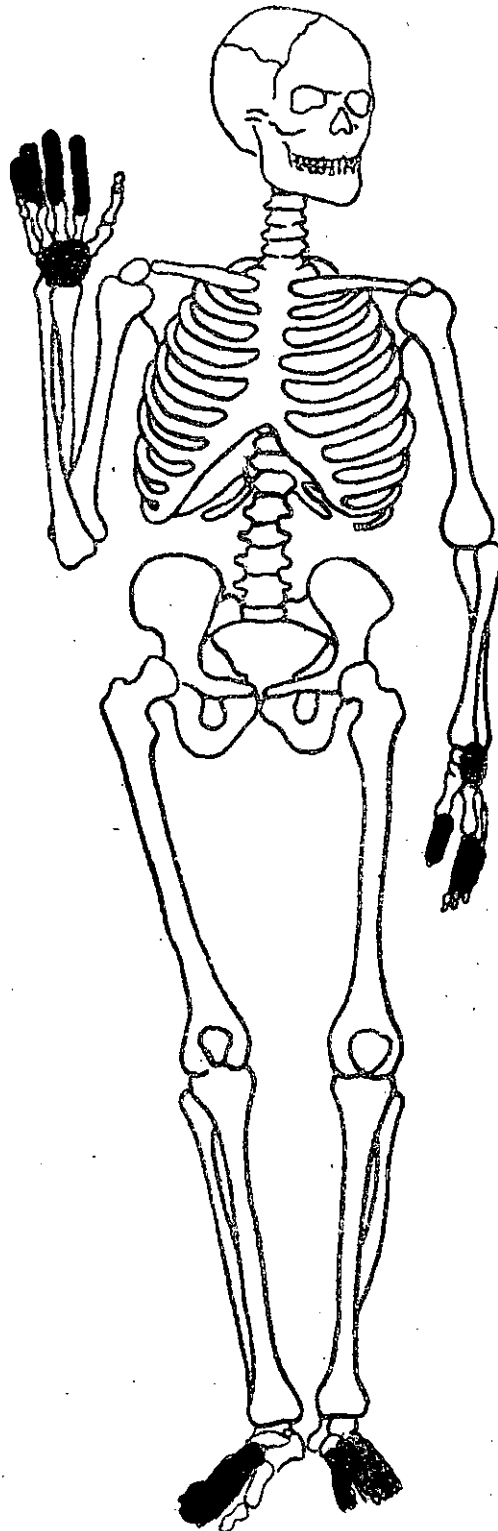

CHART "A"

- a. What information was contained thereon?
- b. Where was the information obtained?
- c. By whom?
12. What is the date of death? **Est: June 1946**
- a. Give basis
13. What is the cause of death? **Drowning in Rhine River**
- b. Give basis **Remains removed from Rhine River, 5 July 1946**
14. What is the date of burial? **Est: 1 August 1946**
- a. Give basis **From German civilians**
15. What was the place of death? **Unknown** Coords
- b. Give basis
16. Where were the remains found? **Rhine River, Guntersblum, Ger** Coords **WM-4533**
- a. By whom? **Ludwig Biehn**
- b. Is sketch attached?
17. Was a casket used? **Yes** Who furnished the casket? **City of Guntersblum, Ge**
- Type of casket **Wooden** How marked? **Not marked**
18. Who made the burial **German civilians of Guntersblum, Germany**
(Civilian, American Mil. or German Mil.)
- a. What are the names and addresses? **Schmitt, 34 Wortaderstrasse; Ludwig Biehn, 12 Steinweg, Oppenheim; Hermann Weber, Burgemeister, Ludwigshoh.**

SECTION B — AIR CORPS DECEASED (To be completed only if deceased is believed to be a member of the AAF).

19. Were remains found in the plane wreckage? **DOES NOT APPLY.**
- a. Give location in plane from which the bodies were removed
- (Tail gunner, pilot, radio, turret, etc., or front, side of plane)
- b. Near wreckage?
20. Scene of crash must be investigated. Give complete results of investigation (if removed, state when and by whom).
- a. Type of Plane
- b. Markings and/or name on plane
- c. Give numbers on motors, machine guns, instruments, radios or other equipment:
21. How did crash occur?
- Enemy Planes?
- Collision?
22. Did plane explode in the air?
- On ground?
23. Did plane burn in the air?
- On ground?
24. What was the direction of the flight?
25. What was the civilian opinion regarding destination of plane?

- 26. Had bombs been released prior to the crash?
- 27. Does specific time and date of crash correspond with date of death of above named deceased?
- 28. Number of planes in formation prior to crash
- 29. State precise time and date of plane crash (Night?) (Day?)
- 30. Were parachutists seen? How many? Escaped?
- Prisoners?

SECTION C — ARMORED CORPS DECEASED (To be completed only if deceased is believed to have been a member of the Armored Force).

DOES NOT APPLY.

- 31. Were remains found in wreckage of a tank?
- a. Give specific position in tank from which deceased was removed
- (Radio man, driver, assistant driver or . . . front, side, or back)
- b. Near wreckage?
- 32. Location of destroyed tank must be investigated. Give complete results of investigation. (If removed, state when and by whom)
- a. Type of tank
- b. Markings and/or name of tank
- c. Numbers on motors, machine guns, ammunition, instruments, etc
- 33. What was the type of enemy action that resulted in the tank's disablement?
- 34. Did tank explode? Burn?
- 35. Number of tanks in immediate vicinity at time of disablement
- 36. Does specific time and date of disablement correspond with date of death of above named deceased?
- 37. Precise time and date of destruction of tank (Night?) (Day?)
- 38. Did any of the crew members escape? Prisoners?

SECTION D — OTHER BRANCH (To be filled out if B & C are not applicable).

- 39. Did death occur from any other means? (i. e., truck, jeep, mines, drowning, or small arms fire) **Drowning**
- If so, give complete and thorough results of the interrogation. **Yes**
- a. Are all certificates and statements of people who possessed knowledge of the case attached? **Yes**
- 40. State the specific clues and evidence that were obtained in securing the name and facts regarding the above listed deceased

SECTION E — GENERAL (To be completed by investigation in all cases)

- 41. Were personal effects recovered by the investigating team? **No**
- If not, state reason **There were none**
- a. Were identification tags found at the time of death? **No**
- Where? By whom?
- Present disposition

If deceased is not identified, personal effects will not be forwarded to PE Depot, but will remain with this form until final identification is made, or investigation is abandoned.

- b. Were personal effects found at the time of death? **No**
 Where? _____ By whom? _____
 Present disposition _____
- c. Was deceased identified by living members of the crew at the time of death? **No**
- d. Did Cemetery Register or cross indicate the immunization shot? **No**
42. Was Deceased given first aid? _____ If so, where? _____
 By whom? _____ Are statements from the medical people attached? **No**
43. Was deceased evacuated to a German civilian hospital? **No**
 Where? _____ Names of people concerned _____
44. Is it possible on surface investigation to obtain from civilian sources a physical description of the deceased? **Yes**
45. Is it possible on surface investigation to obtain from civilian sources the condition of the remains? _____
Bloated from drowning
 (Burnt? Decapitated? etc)
46. Do facts surrounding death show any evidence that it might be an atrocity case? **No**
 a. If so, give basis for positive assumption _____
 b. If so, has higher headquarters been notified? _____
47. Was case previously investigated? **No** By whom? _____
 When? _____
48. Give full names, addresses, and information obtained from each person interviewed _____
49. Are all positive statements regarding identification and particulars surrounding death attached? **Yes**
50. Has any information been given concerning isolated burials in the area outside the immediate vicinity? **No**
51. Was investigation preceded by advanced publicity? **No**
 (If special investigation, give case number) _____
52. Give Brief Narrative **(See Attached Narrative)**

(Use attached, sheets if necessary)

Signature of Interpreter

Rank ASN

Organization

Henry A. Levesque
 Signature of Investigator

HENRY A. LEVESQUE
T/5 31481580
 Rank ASN

164th QM Bn., APO 403
 Organization

N A R R A T I V E

On 3 April 1947 I was sent to disinter the remains of an unknown deceased that were removed from the Rhine River on 5 July 1946. The only clothing the deceased had on was a pair of swimming trunks which were marked with one (1) letter and four (4) numbers, M-4248. A Catholic funeral was held on/or about 1 August 1946 in the town of Guntersblum, Germany. The German civilians furnished a wooden casket and buried the remains.

The following description was given by civilians, Build: large with broad shoulders, Height: 190 cm, Hair: dark brown.

A check was made with A.G. Casualty Clearance in Frankfurt with negative results, and they stated that, there were no current deceased that died in 1946 that are still missing.

Henry A. Levesque
HENRY A. LEVESQUE
T/5 31481580

NOTICE:

Guntersblum, 1 April 1947

SUBJECT: Unknown body washed ashore.

20 Hours

On 5 July 1946 in the district of Ludwigshöhe on the Rhine, an unknown body of a man was washed ashore. The body was naked except for bathing trunks. The bathing trunks had a trade mark on them, written in English.

Following is a description that could be made of the body: Build: large with broad shoulders, Height: 190 cm, Hair: dark brown. On the whole body no other identification, such as rings and ect. could be made. It was established that the body was aged forty (40) to fifty (50) years at the time of drowning, also that the body had been in the water approximately eight (8) to fourteen (14) days.

The body was buried in the cemetery of Guntersblum, section B, Grave No. 194.

The truth of this Notice is herewith certified.

The Undertaker
s/ Kath Sonneck

Guntersblum, 1 April 1947
The Burgermeister

s/ Trumpler
t/ TRUMPLER

s/ Mr. John DeLong
WD. Civ. 21785
Investigator

P.S. The trade mark that was on the bathing trunks was taken away by the French Gendarmerie.

I certify that this is a true translation
to the best of my ability.

Millie Kesselring
Millie Kesselring

A TRUE COPY:

Richard W. Secor
RICHARD W. SECOR
Capt. Inf.
Operations Officer

Notiz:

Guntersblum, den 1.4.1947

Betr.: Landung einer unbekanntes Leiche.

20 Uhr

Am 5. Juli 1946 wurde am Rhein in der Gemarkung Ludwigshöhe eine unbekanntes männliche Leiche gelandet. Die Leiche war unbekleidet und nur eine Badehose am Leibe. Die Badehose hatte eine Firmenmarke in amerikanischer Schrift. Von der Leiche wurden folgende Einzelheiten festgestellt. Gestalt: gross und breitschulterisch Grosse bis 190 cm. Haare: dunkelbraun. Am ganzen Körper waren sonst keine Erkennungszeichen wie Ringe usw. vorhanden. Es wurde festgestellt, dass die Leiche im Alter von 40 - 50 Jahren ertrunken ist, und dass dieselbe ungefähr 8 - 14 Tage im Wasser gelegen hat.

Die Leiche wurde in Guntersblum auf dem Friedhof beigesetzt und zwar unter Abteilung B Grab-Nr. 194.

Für die Richtigkeit der obigen Notiz und Aufstellung:

Die Leichenfrau:
The Undertaker
gez. Kath. Sonneck

Guntersblum, den 1. April 1947
Der Bürgermeister
gez. Trumpler
t/ TRUMPLER

gez. Mr. John Delong
WD. Civ. 21785
Investigator

NB. Die Firmenmarke, welche an der Badehose befestigt war wurde von der franz. Gendarmerie mitgenommen.

French Gendarmerie
of Occupation
1st Legion
Company of Mainz
Section of Mainz
Brigade of Oppenheim
No. of Bds: 459, 5-7-46.
Information on the discovery
of a deceased in the Rhine river.

-Copy-

nb.
On 5 July 1946 the body of a deceased
was found in the Rhine river in
the town of Guntersblum

- Personal Description-

(Extract of verbal statement # 459)

In a small house situated in the local cemetery, the body of a
deceased, dressed in linen khaki shorts, is placed in a casket. The body
is in a badly decomposed condition. It is black and bloated. The remains
are those of a man of approximately 30 years of age. Large build, waist:
about 175 cm, hair dark chestnut brown and waved, teeth in good condition.
No I.D. tags could be found on the body

On the shorts there is the number M-4248 written with ink, the
letters in the height of 10 mm. No trace of wounds can be seen on the body.

The Chief of the German Gendarmerie of Guntersblum has handed a
medical certificate of the examination made by the German medic of Guntersblum
to the French Gendarmerie.

Names and addresses of witnesses:

- 1) Mr. Schmitt, Melchior, fisher
living in Oppenheim, 34 Worstadter-Street.
- 2) Bihn, Ludwig, fisher, living in Oppenheim
No.12, Steinweg.
- 3) Mr. Weber, Hermann, 40 years
Burgermeister of Ludwigshöhe.

A certified true copy: Oppenheim, 3 April 1947

s/ M.d.I. Chief FLOUREN
Brigade Commander
Gendarmerie Legion
of Occupation,
Brigade of Oppenheim.

I certify that this is a true translation
to the best of my ability.

Hilse Böhler
HILSE BÖHLER
Interpreter.

A True Copy:
Richard W. Secor
RICHARD W. SECOR
Capt Inf
Operations Officer

Gendarmerie Française
d'Occupation

Ière Legion

Compagnie de Mayence

Section de Mayence

Brigade de Oppenheim

No Bde 459, du 5-7-46

Procès-verbal
d'enseignements/
découverte d'un cadavre
dans le Rhin.

C O P I E

Le cinq Juillet 1946, un cadavre a été découvert
dans le Rhin, à Guntersblum.

----- SIGNALEMENT -----

((EXTRAIT DU PROCES-VERBAL No 459))

Dans une maisonnette située dans le cimetière
de la localité, le corps d'un homme vêtu d'un caleçon
de laine KAKI est déposé dans un cercueil. Son état
de décomposition est très avancé. Le corps est noir et
enflé. Il s'agit d'un homme d'une trentaine d'années.
corpulence herculéenne. Taille 1 mètre 75 environ,
cheveux châtains foncés et ondulés. Bonne dentition
, aucune plaque d'identité militaire n'a été trouvée
sur le cadavre. Sur le caleçon, est relevé le
matricule M-4248, inscrit à l'encre grasse en lettres
et chiffres de 10 m/m de hauteur.
Aucune trace de coups ou de blessures n'est apparente
sur le corps.

Le Chef de Gendarmerie Allemande de Guntersblum
a remis sur demande de la Gendarmerie Française, un
certificat médical des constatations faites par le me-
decin allemand de Guntersblum.

Noms et adresse des déclarants

- 1) Monsieur SCHMITT, Melchior, batelier demeurant à
Oppenheim 34 Wortaderstrasse Nr.
- 2)- BIEHN, Ludwig, pecheur demeurant No 12, Steinweg à
Oppenheim.
- 3)- monsieur WEBER, Hermann, 40 ans, maire de Ludwigshöhe
- 4) -----

Copie certifiée conforme à l'origi-
nals.

Oppenheim, le 3 août 1946
Le M. d. d. d.

Lageplan

des Irabes

der geländeten unbekanntan Leiche

Friedhof Guntersblum

Zeichenerklärung:

■ Irab des Geländeten 194(-B)

▨ Friedhofsmauer

Ausgefertigt:

13. Juli 1946

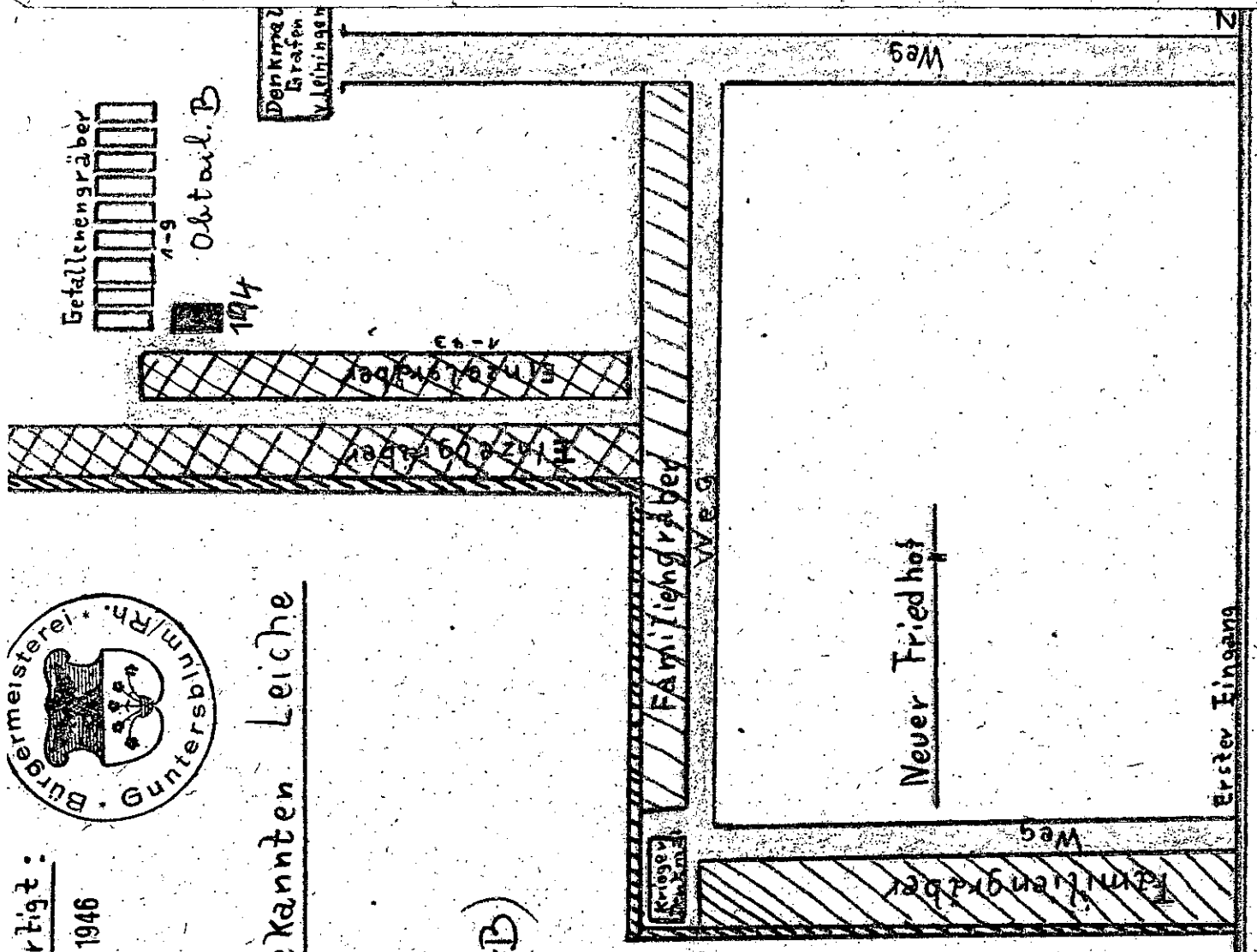

Nach Guntersblum

Worms

← nach Strasse nach →

RESTRICTED



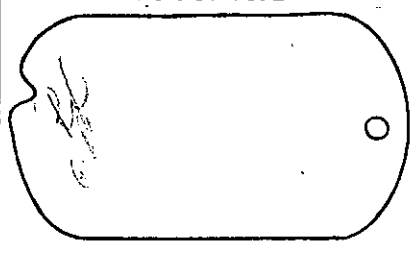

13-1009

WD QMC FORM 1042 (Rev. 1 Apr. 1945) (Supersedes GRS Form 1)		REPORT OF INTERMENT (AR 30-1810 and AR 30-1815)				DATE OF REPORT 9 June 1947		
Imprint Identification Tag If Possible. DO NOT TYPE 		Section 1.—IDENTIFICATION. NAME (Last, first, middle initial) unknown X-5457						
		GRADE unknown		ORGANIZATION unknown		SERIAL No. Unknown		
		RACE unknown		RELIGION unknown		BRANCH OF SERVICE unknown		
						IF OTHER THAN U. S. DEAD, GIVE NAME OF COUNTRY		
PLACE OF DEATH washed ashore Rhine River district of Ludwigshohe, Germany		CAUSE OF DEATH Drowning				DATE OF DEATH Est. June 1946 7		
EMERGENCY ADDRESSEE (Name, relationship, and address) unknown								
IDENTIFICATION TAGS FOUND ON BODY (1, 2, or none) None		IF NO TAGS FOUND ON BODY, DESCRIBE MEANS OF IDENTIFICATION (If unidentified, fill in section 3 on reverse)						
WERE SUBSTITUTE TAGS PROVIDED?(Yes or no) Yes								
LIST PERSONAL EFFECTS FOUND ON BODY AND DISPOSITION OF SAME None								
Section 2.—BURIAL. If other than in established cemetery, furnish sketch and map coordinates on reverse.								
NAME, NUMBER, COORDINATES, AND LOCATION OF CEMETERY U.S. Military Cemetery, Neuville en Condroz, Belgium (VK 390167)								
DATE OF BURIAL 9 June 1947		HOUR 1500	BURIED IN (Shroud, blanket, or name of other) Casket		TYPE OF GRAVE MARKER Temp. wood cross	PLOT No. U	ROW No. 12	GRAVE No. 290
WAS THIS A REBURIAL? (Yes or no) Yes		IF A REBURIAL, INDICATE NAME, NUMBER, COORDINATES OF PREVIOUS CEMETERY, AND LOCATION OF GRAVE Guntersblum Friedhof, Germany WM 4535				PLOT No. B	ROW No. -	GRAVE No. 194
TYPE OF RELIGIOUS CEREMONY Joint P,C & H		PERSON CONDUCTING BURIAL RITES Chaplains Rusher, Saatman & Lepchivcher		IF IDENTIFICATION TAGS NOT USED, DESCRIBE IDENTIFICATION DATA AND CONTAINERS BURIED WITH BODY Report of Burial				
IDENTIFICATION TAG BURIED WITH BODY (Yes or no) No		IDENTIFICATION TAG ATTACHED TO MARKER (Yes or no) GRS						
BODY BURIED ON DECEASED LEFT, NAME (Last, first, middle initial) Reynolds, Amos			RANK Pfc.	SERIAL No. 33662216	ORGANIZATION 10 AmdDiv	GRAVE No. 291		
BODY BURIED ON DECEASED RIGHT, NAME (Last, first, middle initial) Unknown X-5535			RANK Unk	SERIAL No. Unk	ORGANIZATION Unk	GRAVE No. 289		
SIGNATURE OF PERSON PREPARING REPORT ERNEST C. GADDY CWO USA C.I.P.				SIGNATURE OF GRS OFFICER VERIFYING REPORT RAYMOND G. JOHNSON 1st LT. INF. C.I.P.				
DISTRIBUTION OF REPORT: Signed original for U. S. and allied dead, signed original and one copy for enemy dead, to the Quartermaster General through Headquarters GRS Officer. Copies for retention in theater as prescribed by theater commander.								

RESTRICTED

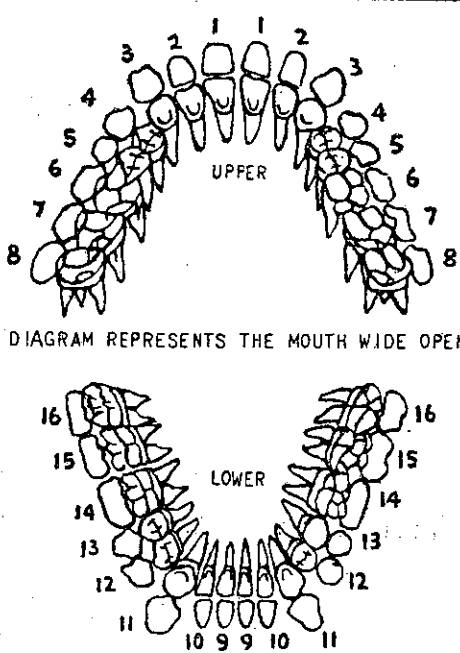
16-43997-1

RESTRICTED

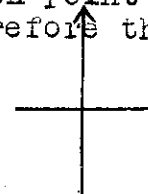
LEFT LITTLE FINGER	Section 3.—UNIDENTIFIED REMAINS.		
	INSTRUCTIONS: (a) Great care will be taken to record the most minute clues for the future identity of unidentified remains. Fill in anatomical characteristics below, and any other clues under "Other," such as shoe size, social security number; position of body found in airplanes, vehicles, and tanks; and serial numbers of airplanes, vehicles, and tanks. (b) A fingerprint, or prints, are the most valuable of all clues. Imprint all fingers and thumbs in the chart at left, or as many as possible. If no fingerprint or prints can be secured, the condition of each and every tooth will be indicated on the tooth chart in accordance with diagram below. Tooth chart will not be accomplished if one or more fingerprints are secured.		
LEFT RING FINGER	HEIGHT Est. 6'1 1/8" UTD	WEIGHT UTD	COLOR OF EYES UTD
	COLOR OF HAIR UTD	BIRTHMARKS, SCARS, OR TATTOOS UTD	
LEFT MIDDLE FINGER	WEAPON AND SERIAL NO. None	LAUNDRY MARKS None	WHERE BODY WAS BURIED OR FOUND Guntersblum Friedhof Germany
	OTHER IDENTIFICATION CLUES Remains were recovered from Cemetery of Guntersblum Friedhof, Germany.		
LEFT INDEX FINGER	According to statement body was washed ashore from the Rhine River in the district of Ludwigshöhe in Germany. The deceased was naked except for swimming trunks marked M-4248.		
	FILLINGS  SILVER FILLING GOLD FILLING	 UPPER LOWER DIAGRAM REPRESENTS THE MOUTH WIDE OPEN	
LEFT THUMB	CAVITIES  CAVITY DECAYED		
	MISSING TEETH  TOOTH MISSING		
RIGHT THUMB	CROWNED TEETH  PORCELAIN CROWN GOLD CROWN		
RIGHT INDEX FINGER	BRIDGE WORK  GOLD BRIDGE		
RIGHT MIDDLE FINGER	FURNISH SKETCH AND MAP REFERENCE AND COORDINATES FOR BURIAL IN OTHER THAN ESTABLISHED CEMETERY		
	Processing at Central Identification point revealed no positive identifying clues, therefore this case is classified unknown. <div style="text-align:center; margin-top: 20px;">  </div>		
RIGHT RING FINGER	REMARKS: Form 11, Check List of Unknowns and Form 1A, Tooth chart accomplished.		
	Unable to obtain fingerprints because of missing portions.		
RIGHT LITTLE FINGER	Estimated weight of remains recovered: 100 lbs.		

RESTRICTED