

FILE IDENTIFICATION TOPPER

FILE NUMBER

*293 Tank. OHL Giesheim/Main (Med) Maus, Germany X-71060*

SUBJECT

\_\_\_\_\_  
\_\_\_\_\_

GPO 83-19180

QMC FORM 1121  
1 Aug 45



**RECORD OF CUSTODIAL TRANSFER**

FROM AGCS MAUSOLEUM, BRITISH/MAIN (MED)		TO USMC FLORENCE, ITALY	
KIND OF CONVEYANCE AIR		NAME OF CONVOYER RICHARD P. WHITE	
SIGNATURE OF SHIPPER <i>Francis M. Simon</i>		SIGNATURE OF RECEIVER <i>Richard P. White</i>	
DATE 10/1/55	DATE 10/1/55		
1. SHIPPED			
FROM		TO	
KIND OF CONVEYANCE		NAME OF CONVOYER	
SIGNATURE OF SHIPPER		SIGNATURE OF RECEIVER	
DATE	DATE		
2. SHIPPED			
FROM		TO	
KIND OF CONVEYANCE		NAME OF CONVOYER	
SIGNATURE OF SHIPPER		SIGNATURE OF RECEIVER	
DATE	DATE		
3. SHIPPED			
FROM		TO	
KIND OF CONVEYANCE		NAME OF CONVOYER	
SIGNATURE OF SHIPPER		SIGNATURE OF RECEIVER	
DATE	DATE		
4. SHIPPED			
FROM		TO	
KIND OF CONVEYANCE		NAME OF CONVOYER	
SIGNATURE OF SHIPPER		SIGNATURE OF RECEIVER	
DATE	DATE		
5. SHIPPED			
FROM		TO	
KIND OF CONVEYANCE		NAME OF CONVOYER	
SIGNATURE OF SHIPPER		SIGNATURE OF RECEIVER	
DATE	DATE		
6. SHIPPED			
FROM		TO	
KIND OF CONVEYANCE		NAME OF CONVOYER	
SIGNATURE OF SHIPPER		SIGNATURE OF RECEIVER	
DATE	DATE		
7. SHIPPED			
FROM		TO	
KIND OF CONVEYANCE		NAME OF CONVOYER	
SIGNATURE OF SHIPPER		SIGNATURE OF RECEIVER	
DATE	DATE		

DATE 10-1-55

FRANCIS M. SIMON, CAPTAIN OMC

RICHARD P. WHITE

USMC FLORENCE, ITALY

FROM AGCS MAUSOLEUM, BRITISH/MAIN (MED)

6

DISINTERMENT DIRECTIVE

293 York-Queshine Maine Mass. X-70060

SECTION A - NAME AND BURIAL LOCATION OF DECEASED

DIRECTIVE NUMBER

DATE

2000

25 September 2000

DAY MONTH YEAR

NAME	SERIAL NUMBER	GRADE	ARM	RACE	RELIGION
X-70000	XXXX				

CEMETERY	PLOT	ROW	GRAVE	DISPOSITION OF REMAINS
Cyprus/Paris			02	2000 CODE 00 DIST. CTR.

SECTION B - CONSIGNEE AND NEXT OF KIN

NAME AND ADDRESS OF CONSIGNEE	NAME AND ADDRESS OF NEXT OF KIN
Werville-on-Ondres, Leige, Belgium	Administrative Decision

SECTION C - DISINTERMENT AND IDENTIFICATION

NAME	SERIAL NUMBER	GRADE	DATE OF DEATH	DATE DISTINTERRED
IDENTIFICATION TAG ON	ORGANIZATION	RELIGION	IDENTIFICATION VERIFIED BY	
<input type="checkbox"/> REMAINS <input type="checkbox"/> MARKER			NAME AND TITLE	

SECTION D - PREPARATION OF REMAINS FOR SHIPMENT

NATURE OF BURIAL	CONDITION OF REMAINS

OTHER MEANS OF IDENTIFICATION

MINOR DISCREPANCIES (Prepare Discrepancy Report QMC Form 1194a for major discrepancies.)

REMAINS PREPARED AND PLACED IN CASKET

DATE	BY	EMBALMER (Signature)

CASKET BOXED AND MARKED	SHIPPING ADDRESS VERIFIED BY

DATE	BY

I hereby certify that all the foregoing operations were conducted and accomplished under my immediate supervision and that the report above is correct.

SIGNATURE OF AGRS INSPECTOR

REMARKS AND SPECIAL INSTRUCTIONS
Not available

NAN  
See 15 Sept 54  
Kercher

HEADQUARTERS  
USAREUR QM MORTUARY SERVICE DETACHMENT, 7770TH ARMY UNIT  
APO 757, c/o Postmaster, New York, N. Y.

993 41K - *Unknown Main Mausoleum X-70060*

CERTIFICATE OF UNIDENTIFIABILITY OF REMAINS

1. The records pertaining to Unknown X-70060, Plot, Row Grave 62, USMC Griesheim/Main (Med) Mausoleum, have been reviewed in accordance with par 159, SR-830-110-5, DA dated 3 March 1949, and it is the opinion of the Board of Review appointed by par 1, SO 9, Headquarters, USAREUR QM Mortuary Service Detachment, 7770th Army Unit, dated 19 June 1954, that sufficient evidence is not available to establish the identity of the deceased concerned, and it is recommended these remains be classified as unidentifiable.

2. Report of reprocessing of remains was forwarded to the Office of The Quartermaster General by Transmittal Letter No. 6514 dated 23 April 1954.

3. Remarks. See attached case history.

*S. Gibbs*

Major S. GIBBS, O-1524255, QMC  
(President)

*Simon J. Hopkins*

Captain SIMON J. HOPKINS, O-1302147, QMC

Captain FRANCIS W. SIMON, O-1590810, QMC

*William M. Loy*

1st Lieut WILLIAM M. LOY, O-2003473, QMC

Received *By Transmittal ltr - 27 Aug 54*  
Not identifiable from *#6533*  
information presently available

**FILE**  
*Regis. Oper. Rec.*  
*2-9-55*

*File - NAT*  
*9 Sept 54*  
*D. E. Sullivan*  
*J. Br.*

CASE HISTORY

UNKNOWN X-70060

Griesheim/Main (Med) Mausoleum

These remains were recovered from the crash site of an allied plane near Fiumefreddo, Sicily. Remains were discovered by a farmer while plowing his field. Information obtained from an eyewitness suggests that the plane crashed during the summer of 1943, however, a definite date of the incident could not be established. A review of captured German Bulag records failed to disclose any data to aid in determining identity of aircraft.

The remains are severely burned and shattered. The only identifying media is an approximate age and a portion of the mandible with six (6) teeth. All major bones with the exception of the proximal halves of the left humerus and femur are missing.

In view of lack of identifying media and insufficient information by which an association can be made it is believed that Unknown X-70060 should be declared Unidentifiable.

*Walter Meybeck*  
WALTER MEYBECK  
20 August 1954

**FIVE**  
*Regis Oper Rec*  
*2-256*

HEADQUARTERS  
 USARMCUR MORTUARY SERVICE DETACHMENT, 7770TH ARMY UNIT  
 APO 757, c/o Postmaster, New York, N. Y.

MTS 293.9 GR

27 August 1954

SUBJECT: Certificate of Unidentifiability  
 Transmittal Letter # 6533

TO: The Quartermaster General  
 Washington 25, D. C.

In compliance with letter, your Office, OMCLET 293, GRS European,  
 Subject: Final Resolution of Unknown Deceased, dated 29 July 1948, for-  
 forwarded herewith are three (3) Certificates of Unidentifiability pertaining  
 to the following remains:

<u>UNKNOWN NO</u>	<u>OBILETERY</u>	<u>GRAVE</u>
X-9210 - <i>see</i>	Griesheim/Main Mausoleum	212
X-9218 - <i>see</i>	Griesheim/Main Mausoleum	220
X-70060 - <i>see</i>	Griesheim/Main (Med) Mausoleum	62

*S. Gibbs*

- 3 Incl
- 1-Cert of Unident  
 w/case history *w/k*  
 X-9210 *w/case*
- 2-Cert of Unident  
 w/case history *w/k*  
 X-9218 *w/case*
- 3-Cert of Unident  
 w/case history  
 X-70060

S. GIBBS  
 Maj MC  
 Commanding

293 APPS GRS European

*File - MTS  
 9 Sept 54  
 Ben Cuy  
 Ed B*

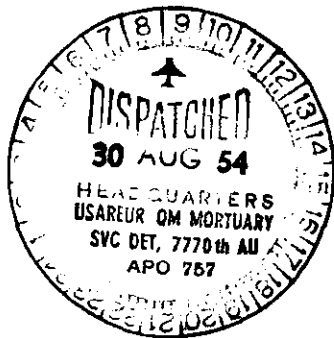

GENERAL DIVISION

1524 SEP 8 PM 2 33

BRANCH



FROM CO 7770 AU USAH AFT GER  
DTG 170945Z AUG  
ACTION QMG  
IN NO 632852

FM HQ USAREUR QM MORT SVC DET 7770TH AU USA HOSP FRANKFURT GER  
TO DEPTAR WASH DC D A GNC

FOR QM PD REF YOUR MSG DA 538889 THIS MSG IN NINE PARTS PD PART ONE CLN  
ACTION INITIATED TO IDENTIFY X-9186 GRIESHEIM MAIN MAUS AS ONE SLASH LIEUT  
ALFRED D MOUSSETTE PD X-9187 GRIESHEIM MAIN MAUS TO BE PROCESSED FOR POSSIBLE  
ELIMINATION OF PART OR ALL PORTIONS WITH IDENTIFIED REMAINS OF FOX SLASH  
GBOE EDWARD J LAHAYE CMM PREVIOUSLY X-717 ST ANDRE CMM NOW PJC ST LAURENT  
PD THIS ACTION DEEMED ADVISABLE TO CLARIFY DIFFERENCES BETWEEN AVAILABLE  
SKELETAL CHARTS FOR X-717 PD TENTATIVE FINDING AND RECOMMENDATION CONCERNING  
X-716 CMM X-719 ST ANDRE CMM AND X-9188 GRIESHEIM MAIN MAUS WILL BE FWD  
ALONG WITH BOARD FINDINGS OF IDENT FOR MOUSSETTE PD PART TWO CLN

CFN 538889 X-9186 X-9187 X-717 X-717 X-716 X-719 X-9188

PAGE TWO UFGC 34R

SUGAR ROGER 710 ASSOCIATED WITH X-6853 ST AVOLD RECOVERED FR. RAKAUDORF  
CMM AUSTRIA PD REVIEW OF RECORDS OF AIRC AFT LOSSES IN AUSTRIAL SUGGESTS  
REMAINS ARE THOSE OF SGT WILLARD S KENDALL CMM HOWEVER NOT CONSIDERED  
CONCLUSIVE PD CURRENT FIELD INVESTIGATION BEING CONDUCTED IN EFFORT TO  
IDENTIFY CRASH SITE PD RESULTS MAY BE EXPECTED SCM SEPT PD PART THREE  
CLN X-9148 GRIESHEIM MAIN MAUS TO BE RETURNED TO ORIGINAL BURIAL SITE AS  
NON-AMERICAN REMAINS PD ACTION PENDING RE-ENTRY INTO DEFERRED SEARCH AREAS  
PD PART FOUR CLN X-9210 GRIESHEIM MAIN MAUS CURRENTLY SUBJ OFFICE RESEARCH  
TO EFFECT ASSOCIATION WITH UNRESOLVED CASUALTY PD RESULTS MAY BE EXPECTED  
ONE SEPT PD PART FIVE CLN X-7000 CLN X-70060 GRIESHEIM MAIN PARENTH MED  
UNPARENTH MAUS SUBJ OR CURRENT OFFICE RESEARCH PD FINDING TO BE FWD NO  
LATER THAN ONE SEPT PD PART SIX CLN X-70061 GRIESHEIM MAIN PARENT MED  
UNPARENTH MAUS PD OFFICE RESEARCH FAILED TO PROVIDE FAVORABLE ASSOCIATION  
PD RESULTS WILL BE FWD TW ZERO AUG PD PART SEVEN CLN BOARD FINDINGS OF  
IDENT FOR TARE SLASH FIVE THURSTON B HOLLAR ASN 14000635 CM FWD YOUR  
OFFICE TRANS LETTER NR 6528 DTD FIVE AUG FIVE FOUR PD PART EIGHT CLN  
JOHN R. SIMONETTI CURRENTLY UNDER INVESTIGATION PD RESULTS MAY BE  
EXPECTED TEN SEPT PD PART NINE CLN DONALD WEST ASN O-886088 CMM PENDING  
ACTION WITH BRITISH AUTHORITIES PD REPRESENTATIVE THIS HQ SCHEDULED TO  
CONTACT BRITISH REPRESENTATIVE ONE EIGHT AUG TO DETERMINE CURRENT STATUS  
YOUR OFFICE WILL BE ADVISED LATEST RESULTS TWO THREE AUG PD SQD MEYRICK

KFNX-6853 X-9148 X-9210 X-70060 X-70061 14 000 5/5 6528 O-886088  
814/1010Z

9 Aug 54

Unclassified

MI DEPTAR WASH DC  
CINUSAC/FR 10 DUISBURG GERMANY

Routine

X

Pass to CG 7770 - FRANK R QM Svc Det From QPOMT

Rqst curr status inves and aprx date results may be expected for fol cases:

X-716, 719 St. Andre; Surger Roger 710, X-9148, 9186, 9187, 9188, 9210 Griesheim/Main

X-70060, 7001 Griesheim/Main (Mediterranean); Thurston Hollar 1400635; John R.

Simonetti 32021788; Donald West 0886088

CCS

Clements/meh

JCM

Unclassified

(DA)

Clarence C. Salser  
QOMT 293  
GRS - EUROPEAN

73880

ALVIN S. PARKER, LT COL, QMC  
Memorial Division

SR 761

## IDENTIFICATION DATA

1. REMAINS OF UNKNOWN X-70060				2. DATE OF REPORT 9 April 1954	
3. NAME OF CEMETERY Griesheim/Main (Med) Mausoleum	4. PLOT	5. ROW	6. GRAVE 62	7. DATE OF	
				DISINTERMENT	REINTERMENT

## PHYSICAL DESCRIPTION

8. ESTIMATED <del>WEIGHT</del> <sup>AGE</sup> aprx. 25	9. ESTIMATED HEIGHT U.T.D.	10. COLOR OF HAIR none	11. RACE U.T.D.
-----------------------------------------------------------	-------------------------------	---------------------------	--------------------

12. GIVE DESCRIPTION OF ANY OFFICIAL IDENTIFICATION FOUND WITH REMAINS

None

13. GIVE DESCRIPTION OF TATTOOS OR SCARS ON BODY AND/OR SUCH INFORMATION OBTAINED FROM OTHER SOURCES

None

14. WAS BODY BURNED? <input checked="" type="checkbox"/> YES <input type="checkbox"/> NO	TO WHAT EXTENT? thruout
---------------------------------------------------------------------------------------------	----------------------------

15. WAS BODY MANGLED? <input checked="" type="checkbox"/> YES <input type="checkbox"/> NO	TO WHAT EXTENT? see attached skeletal chart.
----------------------------------------------------------------------------------------------	-------------------------------------------------

16. DESCRIBE EVIDENCE OF HEALED FRACTURES AND BONE MALFORMATIONS

None

17. LIST EVERY ITEM OF CLOTHING, EQUIPMENT AND PERSONAL EFFECTS FOUND, SHOWING THE TYPE, COLOR, SIZE, MARKINGS, SERVICE, ETC. (If laundry marks are indistinct such notation should be made and specimen forwarded through channels for examination when facilities are not available in the area)

None

Technician: WESLEY A. NEEP

Anthropologist: Prof. E. REBITINGER

SR 761

X-70060

Griesheim/M  
(MED ZONE)  
Grave 62

S K E L E T A L C H A R T

( BLACK OUT PARTS OF BODY NOT PRESENT )

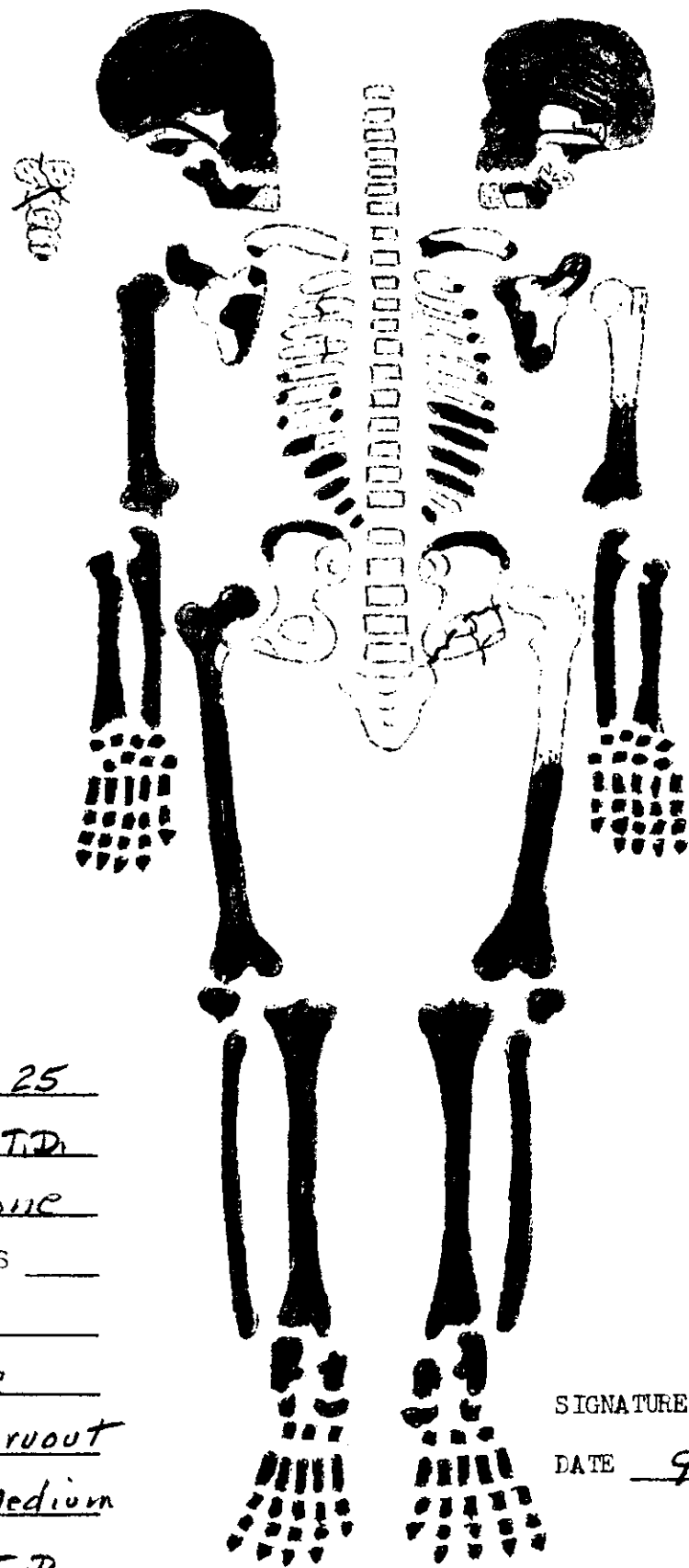

HUMERUS \_\_\_\_\_ CM

ULNA \_\_\_\_\_ CM

RADIUS \_\_\_\_\_ CM

FEMUR \_\_\_\_\_ CM

TIBIA \_\_\_\_\_ CM

FIBULA \_\_\_\_\_ CM

EST. AGE Apix. 25

EST. HEIGHT U.T.D.

COLOR HAIR None

HEALED FRACTURES \_\_\_\_\_

None

FLESH None

BURNED Yes-Thruout

EST. WEIGHT Medium

Race - U.T.D.

SIGNATURE W. A. Heep

DATE 9 April 1954

SR 761

# TOOTH CHART

X-70060  
Griesheim/M (MED) MAUS.  
GRAVE 62

9 April 1954  
Date

Last Name	First	Initial	Grade	Serial No.
Unit			Organization	

Place of Death	Date of Death	Cause of Death
----------------	---------------	----------------

Right

Left

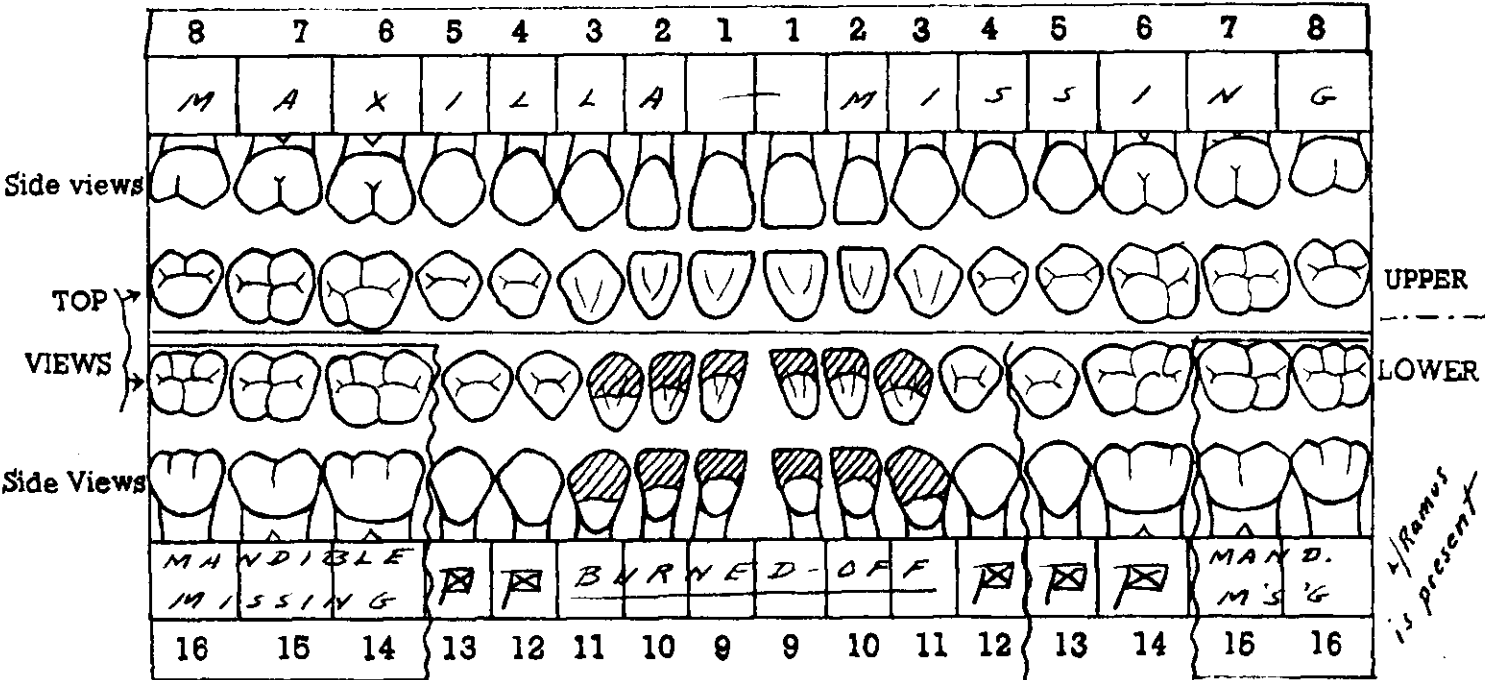

This dental chart is very important and should be filled in with great care. There are 32 teeth to be accounted for, as shown by the numbers on the chart. Beginning at the middle line in both upper and lower jaws, the teeth are arranged symmetrically on either side and classed as incisors (cutting teeth), cuspids or canines (tearing teeth), bicuspid (chewing teeth), and molars (principal chewing teeth). An examination should be made and findings charted to cover the following basic conditions: Lost teeth, crowned teeth, bridge work, fillings, caries (cavities of decay), dentures (plates), and any deformity of jaws found. See reverse side for illustrations.

Size - Average

Posthumously

Missing - R12, 13;  
                  - L12, 13, 14.

Mandible burned severely.

Signature of Officer or other person who prepared Tooth chart

R11 rotated Aprx. 35° mesially.

Verified by G. R. C. Officer

ADDITIONAL SPACE FOR FURTHER REMARKS

DENTURES (PLATES)... Draw diagram of relative size and shape of plate, block in teeth attached and indicate retaining clasps on natural teeth with the word "clasp"

		<p>MISSING TEETH... All teeth missing through previous extraction (not those fractured or displaced by recent wounds) should be "X" d out and labeled, thus:</p>
		<p>CROWNED TEETH... Block in solid the crown of tooth (label gold, porcelain, silver or gold and porcelain), thus:</p>
		<p>BRIDGE WORK... Block in solid the crown of tooth (label gold bridge, gold and porcelain bridge), thus:</p>
		<p>FILLINGS... Draw filling on tooth as accurately as possible (block in and label gold, silver, cement), thus:</p>
		<p>CARIES (CAVITIES)... Outline location and size of cavity, shade in thus:</p>

HEADQUARTERS  
USAREUR ON MORTUARY SERVICE DETACHMENT, 7770TH ARMY UNIT  
APO 757  
US ARMY

31 March 1954

NARRATIVE OF INVESTIGATION

I. AUTHORITY AND MATTERS INVESTIGATED:

In compliance with Investigation Directive # 1129, this Headquarters, dated 26 February 1954, Case # Italy/Misc., the undersigned proceeded to Fiumefreddo (26/0611), Sicily, in effort to investigate the circumstances relating to the discovery of remains in the vicinity of Fiumefreddo.

II. FACTS AND CIRCUMSTANCES:

Information received at this headquarters reveal that remains were found near the crash site of an allied plane which crashed in summer 1943.

The markings of a metal disc (manufacture's specification plate), found at the crash site were insufficient to establish identity of aircraft by Air Force records available this headquarters.

III. FINDINGS:

Upon arrival at Fiumefreddo on 22 March 1954, the undersigned contacted the Carabinieri Marshal who stated that on 10 December 1953 Mr. Giuseppe Seroi, inhabitant of Fiumefreddo, Via Calvario # 29, reported to him that he discovered a few human bones while he was plowing his field, the partial remains were found at the crash site of a fighter plane that fell in summer 1943.

The Carabinieri Marshal, with the help of cemetery workers and city police, excavated the crash site and recovered additional portions of remains. According to the Marshal, the last portions were at approximately one foot deep.

The undersigned proceeded to the crash site, Mr. Seroi and his farm hands proceeded to excavate the spot where the remains were found, but it could be noticed that the plane did not leave a large crater, no further identification media or partial remains were found. (Attention is invited to exhibit "A" location of crash site). According to Mr. Seroi and a city policeman, who witnessed the crash, the plane fell horizontally and was all in flames; several months later the civilian population striped the plane and sold it.

No records were available of the crash incident at the City Hall or at the Police Station.

( Narrative of Investigation, ID # 1129, dated 31 March 1954 cont'd )

The remains found at the crash site were disinterred from the cemetery where they were temporary buried, and turned over to the undersigned.

IV. CONCLUSION:

Above remains were evacuated to Griesheim Mausoleum for further processing and assigned SR # 761.

V. RECOMMENDATION:

Due to the results of this investigation, it is recommended that remains be processed as unknown, and the case be closed.

*Marian Daczynski*  
MARIAN DACZYNSKI  
Sgt RA 42066317  
Investigator

*George N. Sarantos*  
GEORGE N. SARANTOS  
1st Lt QMC  
Investigator



IE # 1129  
Case # 1204/M  
SR # 761

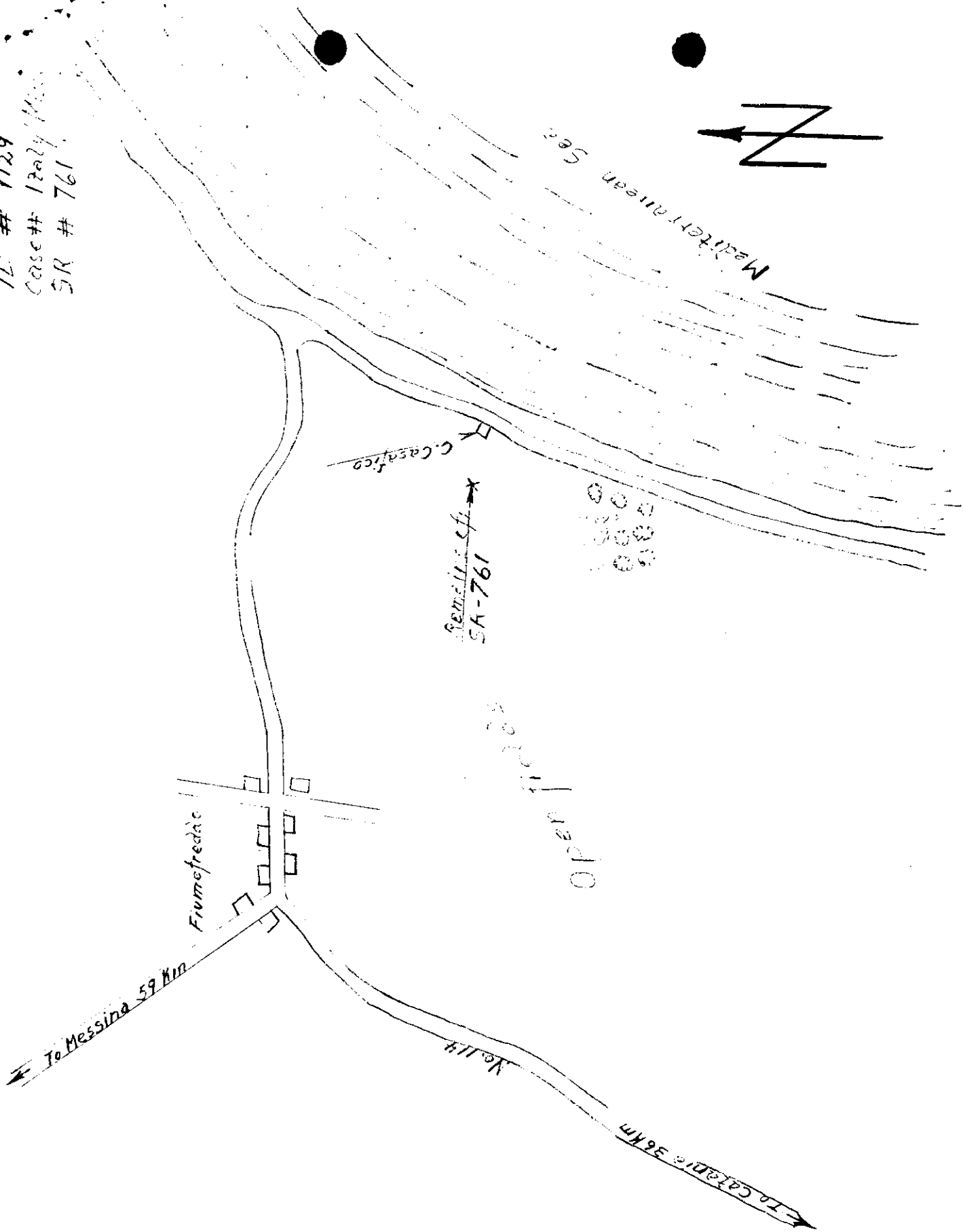
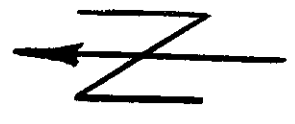

# REPORT OF BURIAL

12 April 1954

Unknown X-70060		Unknown		Unknown	
Last Name	First	Initial	Rank	Serial No.	
Unknown		Unknown			
Unit Fiumefreddo, Sicily		Organization Summer 1943		Cause of Death Plane crash	
Place of Death		Date of Death		Cause of Death	
1600 hours 12 April 1954		Griesheim (Med) Mausoleum		Frankfurt/M, Germany	
Time and Date of Burial		Name of Cemetery		Name or Coordinates of Location	
62					
Grave Number	Row Number	Plot Number		Type of Marker	

Disposition of Identification Tags : Buried with body Yes  No  Attached to Marker Yes  No

If No Identification Tags  
How were remains identified?

What means of identification were buried with the body?

To determine Right or Left use Deceased's Right and Left.

Who is buried on :

Deceased's Right :	Name	Serial No.	Rank	Organization	Grave No.
Deceased's Left :	Name	Serial No.	Rank	Organization	Grave No.

Signature of Name, Rank and if possible Organization of person furnishing above Data when other than officer reporting burial.

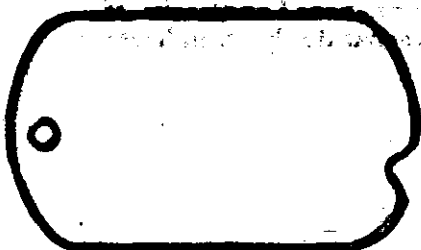

If print of identification tag is not affixed fill in below :

Emergency Addressee..... Name

Address.....

Religion..... Unknown

List only Personal Effects Found on Body and disposition of same :

Recovered as M761 from allied fighter  
plane crash site at Fiumefreddo  
(26/0611) Sicily.

*Francis M. Simon*

Signature of Officer or other person reporting burial

FRANCIS M. SIMON, Captain MC

Verified by G.R.S. Officer

*NAC  
file  
10 May 54  
Mussake  
Ident fr*

# IF DECEASED UNIDENTIFIED

Take Fingerprints of Both Hands. If unable to obtain a complete set of Fingerprints, Take Those You Can, and fill in the following :

- |                 |                           |
|-----------------|---------------------------|
| Height :        | Laundry Marks :           |
| Weight :        | Number of Rifle :         |
| Color of Eyes : | Wear Glasses ?            |
| Color of Hair : | Is Tooth Chart Attached ? |
| Race :          |                           |

(If possible, have medical personnel take a tooth chart, if no medical personnel present, fill in a tooth chart below.) In space below, locate, and describe any scars, birthmarks, moles, deformities, etc.

Note below any identifying clues found, such as letters, photography, probable organization of deceased, etc. :

Left Hand

Thumb

Right Hand

## TOOTH CHART

		Deceased's Left							
		8	7	6	5	4	3	2	1
Upper	Right								
Lower	Right								
Upper	Left								
Lower	Left								

Indicate missing natural teeth by X ; crowns by O ; fillings by □ ; Bridges by ○ linking anchor teeth ; replacements by artificial teeth X

Characteristics :

Other Data :

If this is an Isolated Burial, make a Sketch of the Location, oriented with Permanent Landmarks. If more space needed attach separate sheet. Indicate North.

Identification Branch

13 April 1954

INVESTIGATION DIRECTIVE : 1129  
PROCESSING DIRECTIVE : 256  
REMAINS PROCESSED : SR 761 (X-70060)

IDENTIFICATION LABORATORY REPORT

1. The remains received as Search and Recovery Case 761 were recently recovered from the crash site of an allied fighter plane which was shot down during the summer of 1943.

2. This remains has been assigned an Unknown "X" number as follows:

SR 761 is now designated UNKNOWN X-70060  
Griesheim/Main (Med) Mausoleum  
Grave 62

3. Physical characteristics are as shown below:

	<u>AGE</u>	<u>HEIGHT</u>	<u>WEIGHT</u>	<u>HAIR</u>	<u>SHOE</u>
X-70060	Aprox. 25	U.T.D.	Medium	None	None

This remains is severely burned throughout.

4. CAUSE OF DEATH:

The shattered and burned condition of this remains is in agreement with the circumstances of recovery from the crash site of a fighter plane.

  
WESLEY A. NEEP  
USDAC GS-7  
Lab. Ident. Techn.

  
E. BREITINGER  
Professor, Institute of Anthropology  
University of Frankfurt  
Frankfurt/Main, Germany