

6

DISINTERMENT DIRECTIVE

SECTION A —
NAME AND BURIAL LOCATION OF DECEASED

DIRECTIVE NUMBER

1290 01187

DATE

13 08 40

DAY MONTH YEAR

NAME

UNKNOWN - 001450

SERIAL NUMBER

GRADE

ARM

RACE

RELIGION

J O G

CEMETERY

NEUVILLE BELGIUM

PLOT

ROW

GRAVE

DISPOSITION OF REMAINS

A 10 204

1200 20

CODE DIST. CTR.

SECTION B — CONSIGNEE AND NEXT OF KIN

NAME AND ADDRESS OF CONSIGNEE

NEUVILLE-EN-CONDROZ, BELGIUM

NAME AND ADDRESS OF NEXT OF KIN

(BY ADMINISTRATIVE DECISION)

SECTION C — DISINTERMENT AND IDENTIFICATION

NAME

SERIAL NUMBER

GRADE

DATE OF DEATH

DATE DISINTERRED

IDENTIFICATION TAG ON

ORGANIZATION

RELIGION

IDENTIFICATION VERIFIED BY

- REMAINS
- MARKER

UNKNOWN

NAME AND TITLE

SECTION D — PREPARATION OF REMAINS FOR SHIPMENT

NATURE OF BURIAL

CONDITION OF REMAINS

OTHER MEANS OF IDENTIFICATION

MINOR DISCREPANCIES (Prepare Discrepancy Report QMC Form 1194a for major discrepancies.)

REMAINS PREPARED AND PLACED IN CASKET

DATE

BY

CASKET SEALED BY

EMBALMER (Signature)

CASKET BOXED AND MARKED

SHIPPING ADDRESS VERIFIED BY

DATE

BY

I hereby certify that all the foregoing operations were conducted and accomplished under my immediate supervision and that the report above is correct.

SIGNATURE OF AGRS INSPECTOR

REMARKS AND SPECIAL INSTRUCTIONS

HEADQUARTERS
AMERICAN GRAVES REGISTRATION COMMAND
EUROPEAN AREA
APO 58 US ARMY

RRE 293

9 August 1949
(Date)

CERTIFICATE OF UNIDENTIFIABILITY OF REMAINS

1. The records pertaining to Unknown X - 5450, Plot W
Row 12, Grave 294, USMC NEUVILLE, Belgium,
have been reviewed and it is the opinion of this Office that sufficient
evidence is not available at the present time to establish the identity
of the deceased concerned. The remains concerned should be classified as
unidentifiable at the present time.

2. Report of Reprocessing of remains was forwarded to your
Office by Transmittal Letter No. 2372, dated 23-7-47.

3. Remarks:

Case reviewed by undersigned Members of the Board of Review:

Col. H.P. HENRY, O-12589

QMC

E.D. Mulvanity

Lt. Col. E.D. MULVANITY, O-359598

QMC

Major R. BERGER, O-251736

ORD

Capt. Jack C. HAYES, O-1577297

QMC

Capt. E.F. PRICE, Jr. O-1588236

QMC

1/Lt. Edward E. STOUT, O-1594512

CE

TL # 4209 10 Aug 49 UQMG

Not identifiable from
information presently
available

Incl # 11

Full 30 Aug 49

G. R. & E. DIV.
OFFICE OF THE CHIEF QUARTERMASTER
HQ. COM. ZONE, ETOUSA

TOOTH CHART

26 MAY 1947
Date

Unknown X - 5450

Unknown

Unknown

Last Name

First

Initial

Rank

Serial No.

Unknown

A.G.F.

Unit

Organization

Hurtgen Forest, district # 88, Germany

Est. November 1944

B.T.B. Artillery fire

Place of Death

Date of Death

Cause of Death

Right

Left

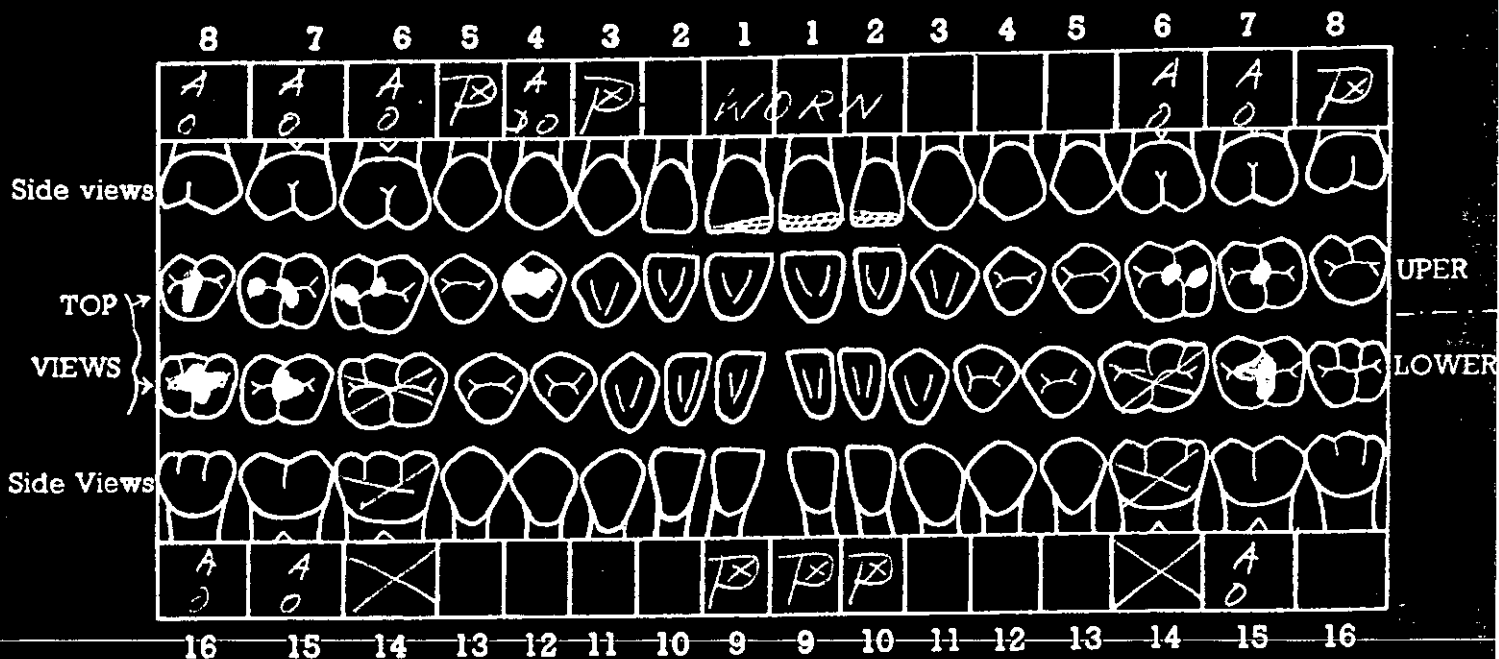

This dental chart is very important and should be filled in with great care. There are 32 teeth to be accounted for, as shown by the numbers on the chart. Beginning at the middle line in both upper and lower jaws, the teeth are arranged symmetrically on either side and classed as incisors (cutting teeth), cuspids or canines (tearing teeth), bicuspid (chewing teeth), and molars (principal chewing teeth). An examination should be made and findings charted to cover the following basic conditions: Lost teeth, crowned teeth, bridge work, fillings, caries (cavities of decay), dentures (plates), and any deformity of jaws found. See reverse side for illustrations.

Harold J. Wheeler
Signature of Officer or other person who prepared Tooth chart

Ernest C. Gaddi
Verified by G. R. S. Officer

ERNEST . C. GADDI
CWO USA C.I.P.

MISSING TEETH . . . All teeth missing through previous extraction (not those fractured or displaced by recent wounds) should be "X" 'd out and labeled, thus:



CROWNED TEETH . . . Block in solid the crown of tooth (label gold, porcelain, Silver or gold and porcelain), thus:



BRIDGE WORK . . . Block in solid the crown of tooth (label gold bridge, gold and porcelain bridge), thus:



FILLINGS . . . Draw filling on tooth as accurately as possible (block in and label gold, silver, cement), thus:

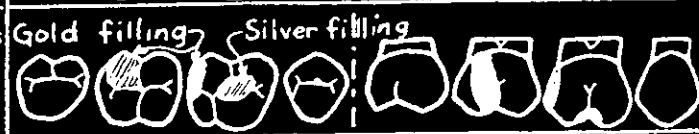

CARIES (CAVITIES) . . . Outline location and size of cavity, shade in thus:



DENTURES (PLATES) . . . Draw diagram of relative size and shape of plate, block in teeth attached and indicate retaining clasps on natural teeth with the word "clasp".

ADDITIONAL SPACE FOR FURTHER REMARKS

Medium size teeth, bleached white from exposure .
 Posthumously missing - R3,5,9, L, 8, 9, 10
 Spaces- R 15-13, 4 mm. L. 15-13, 5 mm.
 Mesial version R 15-16 ; L 15, 16
 L 13 rotated mesially - 1/8 turn
 R 1 ; L. 1,2, worn as shown

177

IDENTIFICATION CHECK LIST

(To be completely filled out and attached to each copy
 of Report of Interment WD QMC Form 1042)

Unknown X 5450
 Cemetery Neuville en Condroz, Belgium
 Plot _____ Row _____ Grave _____

1. ~~Entered in X-1000-XXXX~~ Date processed : 25 April 1947
(Hour) (Date)
2. Place of death Hurtgen Forest, Germany, District # 88
(Name of closest town) (Coordinates and letter Prefix, maps)
W.F. - 0336
(Sheet, scale and serials used)
3. Remains ~~recovered~~ or disinterred by Hq. & Hq., det. 164 QM
(Name and organization)
4. Evacuated to Cemetery by Subordinate Identification Point, Margraten, Holland
(Name and organization)
5. Description of clothing and equipment: (if clothes do not fit, obtain size from body measurements)

Item	Clothing Markings	Sizes	Indicate unusual markings color, wear, tear, repairs, etc.
* Headgear	<u>none</u>		
	<small>(Type)</small>		
Raincoat	<u>Remnants, one (1)</u>		
Overcoat	<u>Wool U.D. Remnants of one (1)</u>		
Jacket, Field	<u>Remnants of one (1)</u>		
Jacket, Combat	<u>none</u>		
Mackinaw	<u>none</u>		
Sweater	<u>none</u>		
Jacket, HBT	<u>none</u>		
* Shirt, Wool OD	<u>Remnants of one (1)</u>		
Undershirt, Wool	<u>Remnants of one (1)</u>		
Undershirt, Cotton	<u>none</u>		
Trousers, HBT	<u>none</u>		
* Trousers, Wool OD	<u>none</u>		

Belt, web none

Drawers, wool none

Drawers, cotton none

Leggings, wool none

Socks, cotton wool O.D. one (1 pr)

* Shoes none (type)

Overshoes none

Web Equipment none (type)

(Other item) Gloves, one (1pair) wool O,D, Leather Palm

(Other item)

* If body is nude, sizes of these items should be computed by measuring the remains

Chevrons or
Insignia none
(Type & location; shirt, jacket, coat, helmet)

Shoulder Patch none

Does clothing indicate that deceased was a member of the Air, Ground or Naval Force?
Ground Forces

6. Description of Remains :
Age Utd Height est 6' 3/8 Weight Utd Description of wounds Utd

Bandages or dressings Utd Scars Utd
(Length, width, location)

Utd Tattoos
(Number, location -- illustrate on separate page)

Outstanding moles, warts or birthmarks Utd
(Yes-no; description, location)

Sunburn or tan, other than hand and face Utd

Complexion Utd
(Light, medium, dark, clear, pimples, pocks, freckles)

Build Utd
(Large, fat, thin, muscular)

Hair Utd
(Color, length, quantity, curly, wavy, straight, whorls, or definite parting)

Hair Utd
(Baldness, widows peak, distinctive cutting or other characteristics)

Sideburns Utd Mustache Utd Beard or Utd
(Color, setting, shape) (Color, size, shape) (Length, heavy)

Goatee **Utd**
 (Light, color, extent)

Eyes **Utd** Eyebrows **Utd**
 (Color, setting, shape) (Color, bushiness, extent across nose)

Nose **Utd** Ears **Utd**
 (Size, shape, straight) (Size, set close to or far from head)

Mouth **Utd** Lips **Utd**
 (Large, medium, small) (Small, large, full)

Teeth **See tooth chart**
 (White, size, unevenness, spacing, noticeable crowns, fillings, extracts)

Chin **Utd**
 (Prominent, receding, pointed, dimples, double)

Jaw **Utd** Circumference of head in inches **21 $\frac{1}{2}$**
 (Large, small, normal) (Hat band)

Neck **Utd** Larynx **Utd**
 (Size, length, short, normal, wrinkled) (Prominent, normal)

Shoulders **Utd** Arms **Utd**
 (Broad, straight, small, rounded) (Length, muscular, color, extent and quantity of hair)

..... **Utd**

Hands **Utd**

Fingers **Utd**
 (Short, thick, long, slender, size of knuckles, missing fingers or joints)

..... (Unusual characteristics of fingernails)

Chest **Utd**
 (Size of nipples, color, quantity and extent of hair, large, small, normal)

Waist **Utd**
 (Size of navel, appendectomy, amount, quantity, and color of hair)

Back **Utd** Circumcision **Utd** Pubic Hair **Utd**
 (Quantity and extent of hair) (Yes-no) (Color)

Hernioplasty **Utd**
 (Yes-no; location)

Legs **Utd**
 (Inseam, muscular, knock-kneed, bowed, normal, quantity, color and extent of hair)

Feet **Utd** Toes **Utd**
 (Size, corns, callouses, flat) (Slender, straight, crooked, overlap)

Evidence of healed fractures **Utd**
 (Nose, arms, legs, etc.)

NOTE: Use attached charts "A" and "B" to indicate parts not received.

7. Have finger prints been placed on Report of Interment? No
(Yes-no)

If not, explain Too decomposed

8. Has tooth chart been prepared? Yes If not, explain
(Yes-no)

9. Remarks Case consists of dry bones and clothing remnants all clothing with but not on body. Height estimated by measuring the following bones: Fibula. 40.1 Tibia. 40.7 - Femur. 49.5 - Humerus 36.4 - Radius 27.4 - and Ulna 29.1
Fluoroscopic Examination: not necessary

Estimated weight of remains recovered : 25 lbs

I certify that I have personally viewed the remains of subject deceased and all resulting information has been recorded to the best of my knowledge.

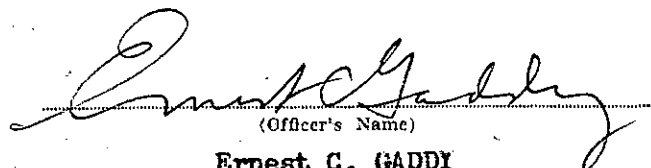
(Officer's Name)

Ernest C. GADDY

C W O U.S.A.

Rank

Service

Central Identification Point
(Organization)

" Remnants of EM " Means of Identification Card " found with remains, were examined by chemical laboratory with negative results. Photo Laboratory Examination revealed (1) Identification Card No. N 073??

(2) In upper right-hand corner :

? 7368 in reverse believed to be transposition of last figures in (1) above.

Prints are inclosed with case papers .

As processing at Subordinate Identification Point, Margraten, Holland revealed no positive identifying clues, this case is classified " Unknown "

SKELETAL CHART

(BLACK OUT PARTS OF BODY NOT RECEIVED AT CEMETERY)

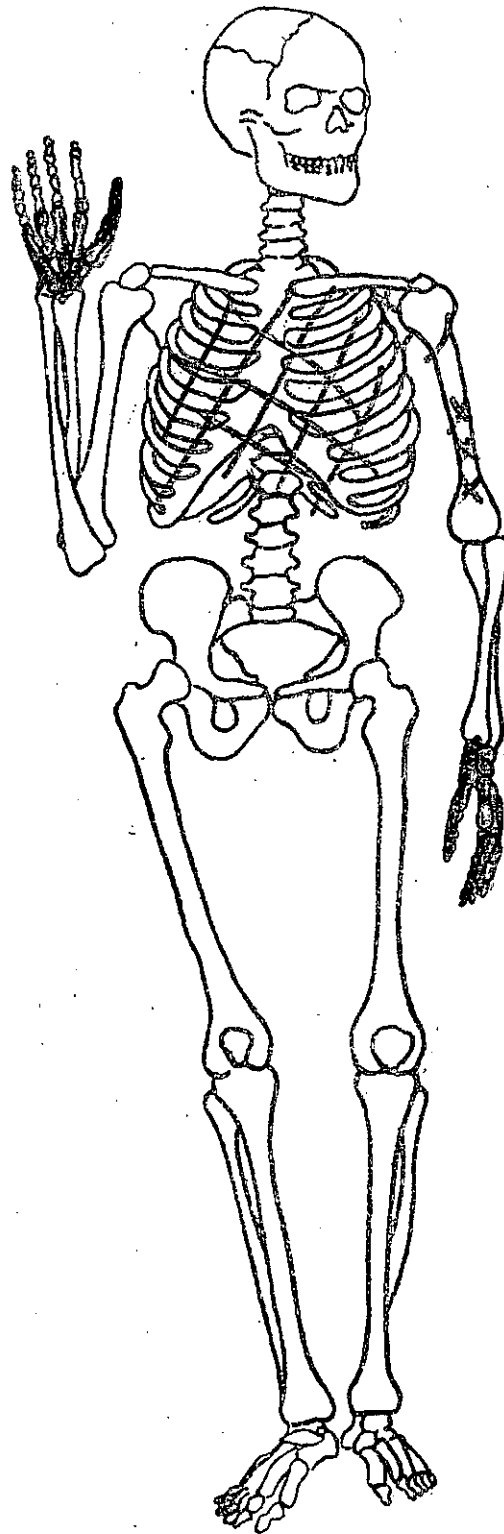

NEUVILLE - en - CONDROZ

Belgium

Unknown X - 5450

- a. What information was contained thereon? _____
- b. Where was the information obtained? _____
- c. By whom? _____
12. What is the date of death? **NOV. 1944 ASSUMED**
- a. Give basis _____
13. What is the cause of death? **ARTILLERY ASSUMED**
- b. Give basis **PLACE OF DEATH (DISTRICT # 88) DESTROYED BY ARTILLERY.**
14. What is the date of burial? **NOT BURIED**
- a. Give basis **REMAINS HERE FOUND ON TOP OF THE GROUND.**
15. What was the place of death? **HURTGEN-FOREST, DISTRICT # 88** Coords **WF-0336**
- b. Give basis **REMAINS HERE FOUND THERE**
16. Where were the remains found? **HURTGEN-FOREST, DISTRICT # 88** Coords **WF-0336**
- a. By whom? **FORESTER LUDWIG PFAFFE, GERMETER, HOUSE # 9**
- b. Is sketch attached? **YES**
17. Was a casket used? **NOT BURIED** Who furnished the casket? _____
- Type of casket _____ How marked? _____
18. Who made the burial **NOT BURIED**
(Civilian, American Mil. or German Mil.)
- a. What are the names and addresses? _____

SECTION B — AIR CORPS DECEASED (To be completed only if deceased is believed to be a member of the AAF).

19. Were remains found in the plane wreckage? **DOES NOT APPLY**
- a. Give location in plane from which the bodies were removed _____
- (Tail gunner, pilot, radio, turret, etc., or front, side of plane)
- b. Near wreckage? _____
20. Scene of crash must be investigated. Give complete results of investigation (if removed, state when and by whom).
- a. Type of Plane _____
- b. Markings and/or name on plane _____
- c. Give numbers on motors, machine guns, instruments, radios or other equipment: _____
21. How did crash occur? _____ Anti-aircraft _____
- Enemy Planes? _____ Collision? _____
22. Did plane explode in the air? _____ On ground? _____
23. Did plane burn in the air? _____ On ground? _____
24. What was the direction of the flight? _____
25. What was the civilian opinion regarding destination of plane? _____

- 26. Had bombs been released prior to the crash?
- 27. Does specific time and date of crash correspond with date of death of above named deceased?
- 28. Number of planes in formation prior to crash
- 29. State precise time and date of plane crash
(Night?) (Day?)
- 30. Were parachutists seen? How many? Escaped?
Prisoners?

SECTION C — ARMORED CORPS DECEASED (To be completed only if deceased is believed to have been a member of the Armored Force).

- 31. Were remains found in wreckage of a tank? **DOES NOT APPLY**
- a. Give specific position in tank from which deceased was removed
(Radio man, driver, assistant driver or . . . front, side, or back)
- b. Near wreckage?
- 32. Location of destroyed tank must be investigated. Give complete results of investigation. (If removed, state when and by whom)
- a. Type of tank
- b. Markings and/or name of tank
- c. Numbers on motors, machine guns, ammunition, instruments, etc
- 33. What was the type of enemy action that resulted in the tank's disablement?
- 34. Did tank explode? Burn?
- 35. Number of tanks in immediate vicinity at time of disablement
- 36. Does specific time and date of disablement correspond with date of death of above named deceased?
- 37. Precise time and date of destruction of tank
(Night?) (Day?)
- 38. Did any of the crew members escape? Prisoners?

SECTION D — OTHER BRANCH (To be filled out if B & C are not applicable).

- 39. Did death occur from any other means? (i. e., truck, jeep, mines, drowning, or small arms fire) **UNKNOWN**
- If so, give complete and thorough results of the interrogation.
- a. Are all certificates and statements of people who possessed knowledge of the case attached?
- 40. State the specific clues and evidence that were obtained in securing the name and facts regarding the above listed deceased **DECEASED COULD NOT BE IDENTIFIED BECAUSE OF MISSING MEANS OF IDENTIFICATION.**

SECTION E — GENERAL (To be completed by investigation in all cases)

- 41. Were personal effects recovered by the investigating team? **NO**
- If not, state reason **NONE COULD BE FOUND**
- a. Were identification tags found at the time of death? **UNKNOWN**
- Where? By whom?
- Present disposition **UNKNOWN**

If deceased is not identified, personal effects will not be forwarded to PE Depot, but will remain with this form until final identification is made, or investigation is abandoned.

UNKNOWN

b. Were personal effects found at the time of death?

Where? By whom?

Present disposition **UNKNOWN**

c. Was deceased identified by living members of the crew at the time of death? **UNKNOWN**

d. Did Cemetery Register or cross indicate the immunization shot? **NOT BURIED**

42. Was Deceased given first aid? **UNKNOWN** If so, where?

By whom? Are statements from the medical people attached?

43. Was deceased evacuated to a German civilian hospital? **NO**

Where? Names of people concerned

44. Is it possible on surface investigation to obtain from civilian sources a physical description of the deceased? **NO**

45. Is it possible on surface investigation to obtain from civilian sources the condition of the remains? **YES**

REMAINS CONSIST OF DRY BONES

(Burnt? Decapitated? etc)

46. Do facts surrounding death show any evidence that it might be an atrocity case? **NO**

a. If so, give basis for positive assumption

b. If so, has higher headquarters been notified? **YES**

47. Was case previously investigated? **YES** By whom?

When?

48. Give full names, addresses, and information obtained from each person interviewed

LUDWIG PFAFFE, FORESTER, GERMETER, HOUSE # 9

49. Are all positive statements regarding identification and particulars surrounding death attached? **YES**

50. Has any information been given concerning isolated burials in the area outside the immediate vicinity? **YES**

51. Was investigation preceded by advanced publicity? **YES**

(If special investigation, give case number)

52. Give Brief Narrative **SEE ATTACHED NARRATIVE**

(Use attached, sheets if necessary)

Signature of Interpreter

Rank ASN

Organization

William B Adams

William B Adams

Signature of Investigator

T/5 RA-6382982

Rank ASN

Hq. & Hq. Det. 164 QM. Bn.

Organization

NARRATIVE
ON HURTGEN, GERMANY CASE.

On 9 April 1947 we proceeded to the Hurtgen-Forest, District # 88, to disinter the remains of an American deceased found by forester LUDWIG PFAFFE, Germeter # 9.

LUDWIG PFAFFE found the remains on his regular course as a forester in this district.

The remains consist of dry bones remaining G.I. equipment. The deceased was recovered near a German Mine-Belt, leading through this area. Wild animals had access to the remains.

No I.D.-tags or other means of identification could be found on the remains.

William B Adams
William B Adams
T/5 RA-6382982

Map : Germany 1/250000
 Sheet : S I
 Coord : (WF - 0336)
 Town : Hurtgen, Germany
 Sketch by : George Geist,
 (German Interpreter)

NOT TO SCALE

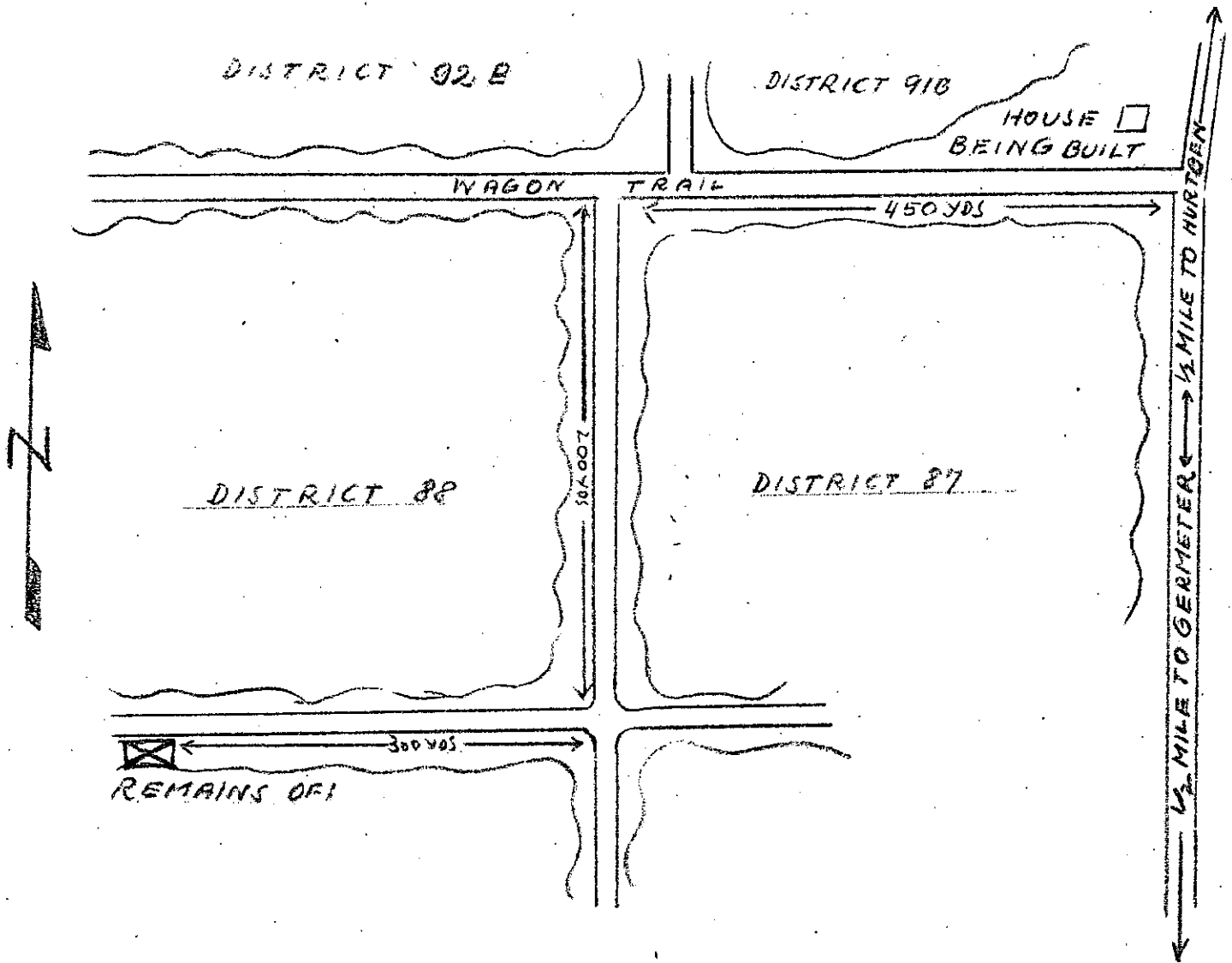

WAR DEPARTMENT
OFFICE OF THE QUARTERMASTER GENERAL
WASHINGTON 25, D. C.

In Reply Refer To
~~XXXXXX~~ OMCGR 293
Burkholder, Marion L.
SN 35 089 448

RECEIVED
14 November 1946
20 NOV 1946
4712
EPC

SUBJECT: Additional Information That May Lead to the Recovery and Identification of Remains Not Yet Accounted For

TO : Commanding Officer
American Graves Registration Command
European Theater Area
APO 887, c/o Postmaster
New York, New York

21	22	23	24	1	2	3
20	- I N -					4
19						5
18	21 NOV 1946					6
17	W. 2377					7
16						8
15	14	13	12	11	10	9

1. Reference is made to letter this office, OMCYG 314.6, Subject: Additional Methods of Locating and Identifying Unknowns and Resolving Cases of Remains Not Yet Recovered, dated 4 October 1946.

2. Attached hereto, in duplicate, is OCMC Form 371 for the following deceased individual whose remains have not yet been recovered or identified:

<u>NAME</u>	<u>GRADE</u>	<u>SERIAL NO.</u>
Burkholder, Marion L.	Private	35 089 448

3. The attached OCMC Form 371 contains all information available from the Office of The Quartermaster General, the Adjutant General, the AG Demobilized Personnel Records Branch and Clinical Records Branch, St. Louis, Missouri, Headquarters, Army Air Forces, and captured enemy documents, and is in addition to any previous information forwarded by this office to your headquarters.

4. It is requested that every attempt be made by your command to locate or identify remains of this individual and the results of your investigation, whether positive or negative, be returned to this office by indorsement hereon, within 60 days of receipt of this communication.

FOR THE QUARTERMASTER GENERAL:
REQUIRED U.S. COMMANDER:
..... Date

P R G

Initial

1 Incl - Par 2

Martin G. Riley
Major, QMC
Assistant

NEGATIVE REPORT

Date 27 Nov 46 Initial *ERS*

(Basic: Ltr WD OQMG, QMGMR 293, ~~Burkholder, Marion L., 35 089 448,~~
dated 14 November 1948)

RRE 293.9 (IB)

1st Ind

Hq American Graves Registration Command, European Area, APO 58 US Army
24 July 1947.

TO: The Quartermaster General, Washington 25, D. C.

1. To date, the remains of Private Marion L. Burkholder, 35089448, have not been recovered.

2. Attention is invited to attached copies of letter and first Indorsement, Hq 164th QM Battalion, dated 21 and 30 June 1947, respectively.

3. For your information.

FOR THE COMMANDING GENERAL:

Incls
a/s

WALTER B. MORROW
Major, Infantry
Actg Asst Adj Gen



HEADQUARTERS
164TH QUARTERMASTER BATTALION
AMERICAN GRAVES REGISTRATION COMMAND
APO 403 US ARMY

21 June 1947

SUBJECT: Isolated burial.

TO : Commanding Officer
164 QM. Bn.
APO 403, US Army

1. A search team was sent to the town of Hurtgen, Germany in search of American deceased and returned with negative results.
2. The whole Hurtgen section which consists of 25 square kilometers has been heavily mined and to date it is only about 3 to 4 % cleared of mines. As this area is demined remains of deceased are being found every day.
3. A number of deceased have been evacuated from Hurtgen. None of the Knowns correspond with the listed deceased.
4. Listed below are the evacuation numbers given the Unknowns that have been disinterred from the Hurtgen Area.
5. Suggest listed deceased be checked with these unknowns.

For THE COMMANDING OFFICER:

hl

WALTER P. BLANTON
1st Lt. Inf
Det. Commander

WFB

IF-1261
IF-1262
IF-1263
IF-1264
IF-1265

IF-1266
IF-1267
IF-1268
IF-1269
IF-1287

IF-1299
IF-1300
IF-1332
IF-1374

(Germany 3)
5676

1st Ind.

RWS/hb.

HQ, 16TH QM. BN, APO 403, US. ARMY,

30 June 1947

TO: Commanding Officer, FPC, APO 403, US. ARMY

1. Forwarded herewith is case (Germany 3, 5676) which is located in an area reported mined.
2. Demining operations are scheduled to be almost completed about 1955.
3. Demining activities are not progressing as fast as is desired, however, it must be remembered that demining operations must necessarily be a slow and tedious process in as much as there is the everpresent risk of life to be considered.

FOR THE COMMANDING OFFICER:

Incl: s/s



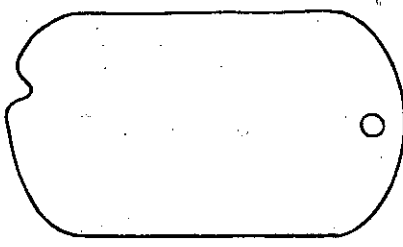

RICHARD W. SECOR
Capt Inf
Operations Officer

TEL: Karlsruhe 776

711

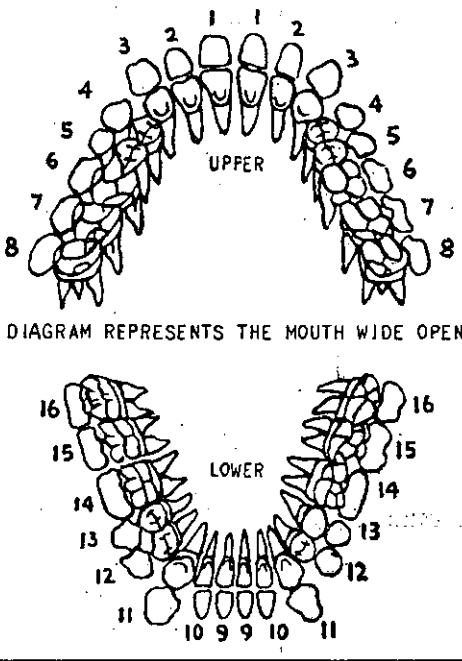
WD QMC FORM 1042 (Rev. 1 Apr. 1945) (Supersedes GRS Form 1)		REPORT OF INTERMENT (AR 30-1810 and AR 30-1815)				DATE OF REPORT 12 June 1947		
Imprint Identification Tag If Possible. DO NOT TYPE 		Section 1.—IDENTIFICATION.						
		NAME (Last, first, middle initial) Unknown X - 5450			SERIAL No. Unknown			
		GRADE Unknown		ORGANIZATION Unknown		BRANCH OF SERVICE A.G.F.		
		RACE Unknown		RELIGION Unknown		IF OTHER THAN U. S. DEAD, GIVE NAME OF COUNTRY		
PLACE OF DEATH Hurtgen Forest district #88, Germany		CAUSE OF DEATH B,T,B, Artillery fire			DATE OF DEATH Est November 1944			
EMERGENCY ADDRESSEE (Name, relationship, and address) Unknown								
IDENTIFICATION TAGS FOUND ON BODY (1, 2, or none) none		IF NO TAGS FOUND ON BODY, DESCRIBE MEANS OF IDENTIFICATION (If unidentified, fill in section 3 on reverse)						
WERE SUBSTITUTE TAGS PROVIDED?(Yes or no) Yes								
LIST PERSONAL EFFECTS FOUND ON BODY AND DISPOSITION OF SAME none								
Section 2.—BURIAL. If other than in established cemetery, furnish sketch and map coordinates on reverse.								
NAME, NUMBER, COORDINATES, AND LOCATION OF CEMETERY U.S. Military Cemetery Neuville en Condroz, Belgium (vk - 390.187)								
DATE OF BURIAL 12 June 1947		HOUR 1500	BURIED IN (Shroud, blanket, or name of other) Casket		TYPE OF GRAVE MARKER Temp. wooden cross	PLOT No. W	ROW No. 12	GRAVE No. 294
WAS THIS A REBURIAL? (Yes or no) no		IF A REBURIAL, INDICATE NAME, NUMBER, COORDINATES OF PREVIOUS CEMETERY, AND LOCATION OF GRAVE Remains found on ground, Hurtgen Forest, district # 88, Germany			PLOT No.	ROW No.	GRAVE No.	
TYPE OF RELIGIOUS CEREMONY Joint P,C & H		PERSON CONDUCTING BURIAL RITES Chaplains Rusher Saatman & Lepchivcher		IF IDENTIFICATION TAGS NOT USED, DESCRIBE IDENTIFICATION DATA AND CONTAINERS BURIED WITH BODY Report of Burial				
IDENTIFICATION TAG BURIED WITH BODY (Yes or no) No		IDENTIFICATION TAG ATTACHED TO MARKER (Yes or no) GRS						
BODY BURIED ON DECEASED LEFT, NAME (Last, first, middle initial) Unknown X-5547			RANK Unk	SERIAL No. Unk	ORGANIZATION Unk	GRAVE No. 295		
BODY BURIED ON DECEASED RIGHT, NAME (Last, first, middle initial) Unknown X-5500			RANK Unk	SERIAL No. Unk	ORGANIZATION Unk	GRAVE No. 293		
SIGNATURE OF PERSON PREPARING REPORT ERNEST C. GADDY CWU USA C.I.F. <i>Ernest Gaddy</i>				SIGNATURE OF GRS OFFICER VERIFYING REPORT RAYMOND G. JOHNSON 1st. Lt. Inf. C.I.F. <i>Raymond G. Johnson</i>				
DISTRIBUTION OF REPORT: Signed original for U. S. and allied dead, signed original and one copy for enemy dead, to the Quartermaster General through Headquarters GRS Officer. Copies for retention in theater as prescribed by theater commander.								

RESTRICTED

LEFT LITTLE FINGER	Section 3.—UNIDENTIFIED REMAINS.				
	<p>INSTRUCTIONS:</p> <p>(a) Great care will be taken to record the most minute clues for the future identity of unidentified remains. Fill in anatomical characteristics below, and any other clues under "Other," such as shoe size, social security number; position of body found in airplanes, vehicles, and tanks; and serial numbers of airplanes, vehicles, and tanks.</p> <p>(b) A fingerprint, or prints, are the most valuable of all clues. Imprint all fingers and thumbs in the chart at left, or as many as possible. If no fingerprint or prints can be secured, the condition of each and every tooth will be indicated on the tooth chart in accordance with diagram below. Tooth chart will not be accomplished if one or more fingerprints are secured.</p>				
LEFT RING FINGER	HEIGHT	WEIGHT	COLOR OF EYES	COLOR OF HAIR	BIRTHMARKS, SCARS, OR TATTOOS
	Est 6'3/8	Utd	Utd	Utd	Utd
LEFT MIDDLE FINGER	WEAPON AND SERIAL NO.		LAUNDRY MARKS		WHERE BODY WAS BURIED OR FOUND
	none		none		Hurtgen Forest, district # 88, Germany
	OTHER IDENTIFICATION CLUES				
LEFT INDEX FINGER	<p align="center">" Remnants of E.M. " Means of Identification card"</p> <p>found with remains, were examined by chemical laboratory with negative results, Photo Laboratory Examination revealed. (1) Identification card No NU73?? . (2) In upper right hand corner : ? 7368 in reverse believed to be transposition of last</p>				
	<p>FILLINGS</p> 		 <p align="center">DIAGRAM REPRESENTS THE MOUTH WIDE OPEN</p>		
LEFT THUMB	<p>CAVITIES</p> 				
	<p>MISSING TEETH</p> 				
RIGHT THUMB	<p>CROWNED TEETH</p> 				
RIGHT INDEX FINGER	<p>BRIDGE WORK</p> 				
RIGHT MIDDLE FINGER	<p>FURNISH SKETCH AND MAP REFERENCE AND COORDINATES FOR BURIAL IN OTHER THAN ESTABLISHED CEMETERY</p> <p>figures in (1) above. Prints are inclosed with case papers. Remains were found on ground in hurtgen Forest, Germany As processing at Subordinate Identification Point, Margraten, Holland, revealed no positive identifying clues, this case is classified " Unknown "</p>				
RIGHT RING FINGER	<p>REMARKS:</p> <p>Form 11, check list of Unknowns and form 1A, Tooth chart accomplished</p> <p>Unable to obtain fingerprints because of decomposition</p> <p>Estimated weight of remains recovered : 25 pounds.</p>				
RIGHT LITTLE FINGER					

RESTRICTED